



# SHRI GURUDATT SUGARS LTD; Takaliwadi

ADD. : Gat No. 61/A, Akiwat Takaliwadi Road, Takaliwadi. Tal. : Shirol, Dist. : Kolhapur (MH) Pin Code : 416 1

PHONE. : +91 231 2686086 | FAX : +91 231 2686000 | WEBSITE : www.sgsl.co.in | Email : gslsugars@gmail.com

SGSL/ENVI/ 459/2024-2025

Date –October 8, 2024

To,  
The Regional Officer,  
Ministry of Environment, Forest & Climate Change,  
Regional office (WCZ), Ground Floor, East Wing,  
New Secretariat Building, Civil Lines, Nagpur.  
Tel No. 0712 – 2531318  
Email: [moefregionalofficenagpur@gmail.com](mailto:moefregionalofficenagpur@gmail.com)

Sub: Six Monthly (April 2024 to September 2024) Compliance Report of Environmental Clearance issued by MoEF & CC, New Delhi.

Ref: Your Letter No. J - 11011/41/2015-IA-II (I) Date - 20.03.2017.

Dear Sir,

With reference to the abovementioned subject and your reference cited above. Please find enclosed herewith Six Monthly (From April 2024 to September 2024) Compliance Report of Environmental Clearance issued by MoEF & CC, New Delhi vide letter no.J - 11011/41/2015-IA-II (I) Date 20.03.2017.

We do hope that you will find the above information satisfactory. However, if you require additional information /clarification in this regard, kindly write back, so that we shall submit the information at the earliest.

Thanking You

Yours Faithfully,

FOR, SHRI GURUDATT SUGARS LTD.,

  
CHIEF EXECUTIVE OFFICER

Enclosed – Compliance Report

C.C to: 1. The Regional officer, MPC Board, Kolhapur.  
2. The Sub - Regional officer, MPC Board, Kolhapur.

<p style="text-align: center;"><b>Shri Gurudatt Sugars Ltd.,</b>  <b>Gat No. 61/A, Akiwat - Takaliwadi Road , Takaliwadi - 416108, Taluka - Shirol, Dist - Kolhapur, Maharashtra</b></p>		
<p style="text-align: center;"><b>Compliance of Conditions Stipulated in environmental clearance granted to expansion of Sugar Plant (From 4900 TCD to 6000 TCD) &amp; Co-generation Power Plant (From 15 MW to 21 MW) by MoEF &amp; CC, New Delhi vide letter No. J - 11011/41/2015-IA-II (I) Date - 20.03.2017</b></p>		
EC No -	J - 11011/41/2015-IA-II (I) Date - 20.03.2017	October 2024
SR. NO.	EC Condition	Compliances
<b>A) Specific Condition</b>		
1	Zero liquid Discharge System shall be ensured	We have full-fledged disposal method carried out in a scientific manner on land for irrigation in available 55 Acres for crop irrigation.
2	Water requirement to be reduced at extent possible by using latest process methodology being used worldwide.	Ours is the first Sugar factory in Maharashtra, wherein, we run the entire industrial activity with treated and recycled condensates, which is accrued from cane and no fresh water is utilized, for sugar factory operation. We have installed Condensate Polishing Unit (C.P.U) for sugar factory excess condensate water treatment and recycled purpose. <b>Annexure 1</b>
3	Fly ash be generated shall be sent to nearby cement industry.	The measurity of fly ash is utilize of our press mud composting yard the remaining of the small quantity is we have sold ash to brick manufactures and farmers.
4	Green belt (10 m wide) of perennial plant species like Neem, Seasam, Teak etc. to be developed around the plant periphery ensuring the 33% area of the plant as green area. The forest department may be consulted in this regard.	We have already planted 16500 Nos of tree as site.
5	Air emission from all point source to be controlled by latest technology instrument. The emissions shall conform to the limits imposed by Maharashtra Pollution Control Board (MPCB)	We have already installed air pollution control equipment as per consent stipulation. The efficiency further increase bagasse drying mechanism was installed.
6	Periodic soil and water sampling in nearby villages and water bodies to be done by the project authorities through 3rd part expert	The soil and water sampling in nearby villages carried out periodically. The report are enclosed as <b>Annexure 2</b>

	and report shall be submitted to the concerned Regional office of the Ministry.	
7	RO plant of sufficient capacity to be installed in the nearby villages to ensure safe drinking water supply. Maintenance of the RO plant will be owned by the project authorities.	The RO plant installed for drinking water purpose and benefits all nearby villages.
8	Health checkup camps to be organized periodically in nearby villages.	The health checkup camps carried out periodically.
9	A regular environmental manager having PG qualification in environmental sciences / environmental engineering to be appointed for looking after the environmental management practices in the plant.	We have already recruit Environmental Engineer having PG Qualification with full-fledged division of Environmental Management, wherein, all our Environmental management Plants are monitored on daily basis, along with requisite analysis carried out in our laboratory by trained chemists.
10	Automatic/ online monitoring system (24*7 monitoring devices) for flow measurement and relevant pollutants in the treatment system to be installed. The data to be made available to the respective SPCB and in the Company's website.	We have already installed and completed the connectivity to CPCB / MPCB server of online monitoring system of ETP outlet water parameter (Flow, PH, TSS, COD & BOD) & Boiler stack (SPM /TPM) . The continuous monitoring results of ETP outlet water parameter & boiler stack emission depict that we are achieving norms stipulated by MPCB on a continuous time basis. And also online monitoring data is uploaded in company website. The photo of instrument is attached as <b>Annexure 3</b> .
<b>B) General Conditions:</b>		
1	The project authorities must strictly adhere to the stipulations made by the Maharashtra Pollution Control Board, State Government and any other statutory authority.	PA agreed to comply with
2	No further expansion or modifications in the plant shall be carried out without prior approval of the Ministry of Environment, Forest and Climate Change. In case of deviations or alteration in the project proposal from those submitted to this Ministry for clearance, a fresh reference shall be made to the Ministry to assess the adequacy of conditions imposed and to add additional environment protection measures required, if any.	PA agreed to comply with

3	<p>The locations of ambient air quality monitoring stations shall be decided in consultation with the State Pollution Control Board (SPCB) and it shall be ensured that at least one station is installed in the upwind and downwind direction as well as where maximum ground level concentration are anticipated.</p>	<p>Complied. Ambient air quality monitoring is being carried out at three (03) location within the plant. PA submitted that the locations were decided in consultation with MPCB. As per the monitoring data, the ambient air quality levels found to be within prescribed limits.</p>
4	<p>The National ambient air quality emission standards issued by the ministry vide G.S.R. No. 826(E) dated 16th November, 2009 shall be followed.</p>	<p>Complied. Acoustic enclosures have been provided. Green belt has been developed around the plant area. As per the monitoring data, the noise levels found to be within stipulated limits. The copy is enclosed as <b>Annexure 4.</b></p>
5	<p>The overall noise levels in and around the plant area shall be kept well within the standards by providing noise control measures including acoustic hoods, silencers, enclosures etc. on all sources of noise generation. The ambient noise levels shall conform to the standards prescribed under Environment (Protection) Act, 1986 Rules, 1989 viz. 75 dBA (day time) and 70 dBA (night time)</p>	<p>Complied. Acoustic enclosures have been provided. Green belt has been developed around the plant area. As per the monitoring data, the noise levels found to be within stipulated limits. The copy is enclosed as <b>Annexure 4.</b></p>
6	<p>The company shall harvest rainwater from the roof tops of the buildings and storm water drains to recharge the ground and use the same water for the process activities of the project to conserve fresh water.</p>	<p>Complied. Roof top harvesting has been provided for the sugar godowns. Two collection pits of capacities 2100 cu.m. and 1600 cu.m. Have been provided for the storage of rain water.</p>
7	<p>Training shall be imparted to all employees on safety and health aspects of chemicals handling. Pre-employment and routine periodical medical examination for all employees shall be undertaken on regular basis. Training to all employees on handling of chemicals shall be imparted.</p>	<p>Complied. Personnel protective equipment has been provided to workers. The report are enclosed as <b>Annexure 5.</b></p>
8	<p>The company shall comply with all the environmental protection measures and safeguards proposed in the documents submitted to the Ministry. All the recommendations made in the EIA/EMP in respect of environmental management and risk mitigation measures relating to the project shall be implemented.</p>	<p>E.S.P, Wet scrubber &amp; bagasse Dryer with a stack of height 65 m has been provided. Effluent treatment plant has been provided. Treated effluent is used in the seed farms of the industry also supplied to the agriculture fields of farmers of nearby villages upon prior request from farmers. Green belt has been provided. Environmental quality monitoring is being carried out. CSR works are being undertaken. Vermi composting is being carried out with the waste generated in the cane yard. Compost is being supplied to the farmers.</p>

9	The company shall undertake all relevant measures for improving the socioeconomic conditions of the surrounding area. CSR activities shall be undertaken by involving local villages and administration.	Complied.
10	The company shall undertake eco-development measures including community welfare measures in the project area for the overall improvement of the environment.	Being complied. As per the details provided, PA distributed 500 nos trees to farmers of nearby villagers under eco-development measures.
11	A separate Environmental Management Cell equipped with full-fledged laboratory facilities shall be set up to carry out the Environmental Management and Monitoring functions.	Complied. Environmental management cell has been established.
12	The company shall earmark sufficient funds towards capital cost and recurring cost per annum to implement the conditions stipulated by the Ministry of Environment, Forest and climate change as well as the State Government along with the implementation schedule for all the condition stipulated herein. The funds do earmarked for environment management / pollution control measures shall not be diverted for any other purpose.	Complied. As per the details provided, PA earmarked an amount of 13.5 cores towards capital expenditure and Rs. 3.31 cores towards recurring expenditure for environmental protection measures.
13	A copy of the clearance letter shall be sent by the project proponent to concerned Panchayat, Zillah Parishad / Municipal Corporation, Urban local Body and the local NGO, if any, from whom suggestion / representations, if any, were received while processing the proposal.	Copy of the environmental clearance submitted to Zillah Parishad, Kolhapur and Gram Panchayat, Takaliwadi on 27.03.2017, The copy is enclosed as <b>Annexure 6</b> .
14	The project proponent shall also submit six monthly reports on the status of compliance of the stipulated Environmental Clearance conditions including result of monitored data (both in hard copies as well as by e-mail) to the respective Regional Office of MoEF & CC, the respective Zonal office of CPCB and SPCB. A copy of Environmental Clearance and six monthly compliance status report shall be posted on the website of the company.	Complied. However same has been uploaded to the company website.
15	The environmental statement for each financial year ending 31th March in Form-V as is mandated shall be submitted to the concerned State Pollution Control Board as prescribed under the Environment (Protection) Rules, 1986, as amended subsequently, shall also be put on the website of the company along with the status of compliance of environmental clearance	Complied. Environment statement for the FY 2023-24 submitted to MPCB vide letter dated 12.04.2024, however the same was uploaded to the company website.

	conditions and shall also be sent to the respective Regional Offices of MoEF & CC by e-mail.	
16	The project proponent shall inform the public that the project has been accorded environmental clearance by the Ministry and copies of the clearance letter are available with the SPCB / Committee and may also be seen at Website of the Ministry at <a href="http://moef.nic.in">http://moef.nic.in</a> . This shall be advertised within seven days from the date of issue of the clearance letter, at least in two local newspapers that are widely circulated in the region of which one shall be in the vernacular language of the locality concerned and a copy of the same shall be forwarded to the concerned Regional Office of the Ministry.	Advertisement regarding to grant of EC was made on 31.03.2017. The copy is enclosed as <b>Annexure 7</b> .
17	The project authorities shall inform the Regional Office as well as the Ministry, the date of financial closure and final approval of the project by the concerned authorities and the date of start of the project.	PA agreed to comply with.
18	The Ministry may revoke or suspend the clearance, if implementation of any of the above conditions is not satisfactory.	PA agreed to comply with.
19	The Ministry reserve the right to stipulate additional conditions, if found necessary. The company in a time bound manner will implement these conditions.	PA agreed to comply with.
20	The above conditions will be enforced, inter alia under the provisions of the Water (Prevention and Control of Pollution) Act, 1974, Air (Prevention and Control of Pollution) Act, 1981, the Environment (Protection) Act, 1986, Hazardous Waste (Management, Handling and Transe-boundary Movement) Rules, 2008 and the Public Liability Insurance Act, 1991 along with their amendments and rules.	PA agreed to comply with.

# Shri Gurudatt Sugars Ltd., Takaliwadi

## ANNEXURE - 1

- 1) The increase in capacity of Sugarcane crushing from 4900 TCD to 6000 TCD is not an expansion in true sense and this is TO CATER FOR REQUIREMENT TO INCREASE CRUSHING BY 10-15% DUE TO CANE HARVESTING REQUIRED TO BE CARRIED OUT AS PER MATURITY, as otherwise there is sugar loss.
  - A) Modernization, **without increasing either resource consumption or pollutional load** is a constant endeavor and as a result, with Technological Advances carried out, we are able to ensure '**NO POLLUTIONAL LOAD INCREASE**' in terms of volume or concentration of effluents, both water and air due to the abovementioned measures. This is clearly depicted in Annexure I and II attached herewith. THAT THERE IS NO CHANGE IN ANY MACHINERY CAPACITY AND THE CAPACITY INCREASE IS ACHIEVED THROUGH THE TECHNOLOGY CHANGES MENTIONED ABOVE.
  - B) DUE TO MEASURES TAKEN FOR CONSERVATION OF RESOURCES, NO INCREASE IN WATER OR FUEL CONSUMPTION IS WARRANTED, THEREBY ACHIEVING ZERO DISCHARGE TECHNICALLY FOR THE EXPANSION MODE.

The salient points of our efforts in above direction are:

- i) Ours is the **first Sugar factory in Maharashtra**, wherein, we run the entire industrial activity with treated and recycled condensates, which is accrued from cane and **no fresh water is utilized**, for sugar factory operation. As given in Annexure I, the same condition prevails for additional capacity as well, wherein, we are not required to consume any raw water, and therefore, there is no effluent generation from the same.
  - ii) We also have installed Bagasse drying mechanism, with waste heat from flue gas, thus minimizing consumption of Bagasse for combustion, thereby effectively reducing the emissions at source itself. We have also taken various measures as given in Annexure II, which depict the sembalance of fuel consumption and therefore there is no air emission increase in this respect.
- 2) We have provided a full fledged Effluent Treatment Plant and operating the same with due vigil. Analysis of the treatment efficiency is a routine and corrective measures are taken immediately.
- 3) We have taken care that no untreated/ treated effluent from factory enters any water course and all the treated effluent is utilized on our own Land for Cane seed Plantation Irrigation, employing scientific practices.
- 4) We have a full fledged division of Environmental Management, wherein, all our Environmental management Plants are monitored on daily basis, along with requisite analysis carried out in our laboratory by trained chemists. We also have installed 'Online Monitoring Systems for Water and Air Pollution Control System monitoring, as per stipulations in this regard.

The above measures have resulted in waste generation minimization, and it implies that there is 'zero increase in pollutional load', due to the measures taken above.

**ANNEXURE I**

**WATER BUDGET FOR EXISTING AND PROPOSED CAPACITY AFTER MODERNISATION AT SHRI GURUDATT SUGARS LTD**

EXISTING 4900 TCD,15 MW					ADDITIONAL 1100 TCD,6 MW				
PURPOSE	INPUT	Purpose	LOSSES	EFFLUENT	PURPOSE	INPUT	Purpose	LOSSES	EFFLUENT
	Cum/d		Cum/d	Cum/d		Cum/d		Cum/d	Cum/d
Water in Cane	3430	Bagasse	686		Water in Cane	770	Bagasse	154	
Imbibition	1470	Mollasses	98		Imbibition	330	Mollasses	22	
Washings	470	Press mud	98	470	Washings (No New Machine)	0	Pressmud	22	0
		(Evaporation & Cooling Loss)	500				Evaporation & Cooling Loss)	100	
Total	5370		1382	470	Total	1100		298	
Condensate	3518	Imbibition	1470		Condensate	798	Imbibition	330	
		Other use	686				Other use	154	
		Washing	470				Washing	0	
Total Internal Use			2626		Total Internal Use			484	



Excess Condensate			<b>892</b>		Excess Condensate			314	
Treated Condensate		Utilization	Cum/d						
		Co-Gen Make-up	450				Co-Gen Make-up	<b>0 ( As Back Pressure Turbine added does not require cooling Tower)</b>	
		Cooling Circuit Make up	120				Cooling Circuit Make up	24	
		Excess to Other Applications	322				Excess to Other Applications	296	

**ANNEXURE II-EFFICIENCY INCREASE IN CO-GENERATION DUE TO IMPROVED TECHNOLOGY**

PARAMETER	EARLIER CONDITION	IMPROVEMENT	IMPACT ON % EFFICIENCY INCREASE
BOILER TPH	<b>70+40</b>	<b>70+40</b>	Nil , Since No Change
Max.Working Steam Consumption	<b>85</b>	<b>104</b>	
Bagasse Consumption	<b>36.95</b>	<b>36.49</b>	Nil , Since No Change
<b>I) STEAM TEMPERATURE INCREASE DUE TO SUPERHEATER MODIFICATION</b>			
A) Steam temperature (°c)	420	500	Positive, as Power Generation Shall Improve For The Same Steam Quantity
B) Enthalpy	777.15	821.79	<b>5.7%</b>
<b>II ) BAGASSE MOISTURE REDUCTION DUE TO IMPROVED MILL SETTING</b>			
A) Bagasse Moisture	50	47	
B) Enthalpy	2273.84	2411.84	<b>6.1%</b>
<b>III ) BAGASSE DRYING MECHANISM BASED ON FLUE GAS</b>			
A) Bagasse Moisture	47	40	
B) Enthalpy	2411.84	2691.80	<b>11.6%</b>
<b>TOTAL INCREASE IN EFFICIENCY</b>			<b>23.4%</b>



Lab Approved by MoEF, New Delhi. (Valid till 05/02/2024)  
Lab NABL Accredited - Testing - Chemical Field (TC - 7064)

"Shree", K 3/4, S. No. 10, Erandawane Housing Society, Opposite Deenanath Mangeshkar Hospital, Pune 411 004.  
• Mobile : 7249867318, 8378018710 • Tel. : 020 - 25460202 • Email : kmn@hespl.co.in / md@hespl.co.in • www.hespl.co.in

### AMBIENT AIR QUALITY MONITORING ANALYSIS REPORT

Report No.	: HS/REP/23-24/15943
Dated	: 24/01/2024
Client	: M/S SHRI GURUDATT SUGARS LTD., TAKALIWADI
Site	: GAT NO.61/A, AKIWAT TAKALIWADI ROAD, TAKALIWADI, TAL-SHIROL, DIST-KOLHAPUR, PIN- 416108.
Sample Collected by	: M/S. GREENSAFE ENVIRO SERVICES

### RESULTS

SR. NO.	TEST DESCRIPTION	UNIT	READINGS	NAAQS STANDARDS	METHOD OF SAMPLING AND ANALYSIS
01	DATE OF SAMPLING	DD/MM/YY	18/01/2024		
02	TEST LOCATION		Near Factory Main Gate		
03	TIME OF SAMPLING	Hrs	09:00-17:00		
04	TEMPERATURE (Max./Min)	Deg C	28/24		
05	RELATIVE HUMIDITY	% RH	63		
06	SAMPLING DURATION	Hrs	8		
07	PM10	µg/m <sup>3</sup>	74.00	≤100	IS 5182(part 23),2006
08	PM <sub>2.5</sub>	µg/m <sup>3</sup>	34.00	≤60	CPCB Guidelines Volume – I Pg. No.15
09	SO <sub>2</sub>	µg/m <sup>3</sup>	7.20	≤80	IS 5182(part 2),2001, RA 2006
10	NO <sub>2</sub>	µg/m <sup>3</sup>	26.80	≤80	IS 5182(part 6),2006

#### Calibrations details: -

Sr. No.	Instrument Name	Serial / Identification No.	Certificate No.	Last Calibrated on	Due Date
1	AFDS-GSES/ADS-01	RDS/FM-01	TECH/CAL/2023/04.C/14	20/04/2023	19/04/2024
2	HVS-GSES/HVS-01	RDS/UM-01	TECH/CAL/2023/04.C/1/2	20/04/2023	19/04/2024

NAAQS – National Ambient Air Quality Standards (2009)

*M. N. Aggarwal*  
For HORIZON SERVICES



#### DISCLAIMER:

- Sample will be retained only for 15 days.
- Above results indicate to the parameters mentioned only.
- Liability limited till issue of test reports only.
- The test report shall not be produced for any legal identity or advertised without permission of lab.
- The effect of results relate only to the item tested.



Lab Approved by MoEF, New Delhi. (Valid till 05/02/2024)  
Lab NABL Accredited - Testing - Chemical Field (TC - 7064)

"Shree", K 3/4, S. No. 10, Erandawane Housing Society, Opposite Deenanath Mangeshkar Hospital, Pune 411 004.  
• Mobile : 7249867318, 8378018710 • Tel. : 020 - 25460202 • Email : kmn@hespl.co.in / md@hespl.co.in • www.hespl.co.in

### AMBIENT AIR QUALITY MONITORING ANALYSIS REPORT

Report No.	: HS/REP/23-24/15944
Dated	: 24/01/2024
Client	: M/S SHRI GURUDATT SUGARS LTD., TAKALIWADI
Site	: GAT NO.61/A, AKIWAT TAKALIWADI ROAD, TAKALIWADI, TAL-SHIROL, DIST-KOLHAPUR, PIN- 416108.
Sample Collected by	: M/S. GREENSAFE ENVIRO SERVICES

### RESULTS

SR. NO.	TEST DESCRIPTION	UNIT	READINGS	NAAQS STANDARDS	METHOD OF SAMPLING AND ANALYSIS
01	DATE OF SAMPLING	DD/MM/YY	18/01/2024		
02	TEST LOCATION		Near Weigh Bridge		
03	TIME OF SAMPLING	Hrs	09:15-17:15		
04	TEMPERATURE (Max./Min)	Deg C	28/24		
05	RELATIVE HUMIDITY	% RH	63		
06	SAMPLING DURATION	Hrs	8		
07	PM <sub>10</sub>	µg/m <sup>3</sup>	86.00	≤100	IS 5182(part 23),2006
08	PM <sub>2.5</sub>	µg/m <sup>3</sup>	57.00	≤60	CPCB Guidelines Volume – I Pg. No.15
09	SO <sub>2</sub>	µg/m <sup>3</sup>	8.10	≤80	IS 5182(part 2),2001, RA 2006
10	NO <sub>2</sub>	µg/m <sup>3</sup>	30.40	≤80	IS 5182(part 6),2006

#### Calibrations details: -

Sr. No.	Instrument Name	Serial / Identification No.	Certificate No.	Last Calibrated on	Due Date
1	AFDS-GSES/ADS-02	RDS/FM-02	TECH/CAL/2023/04.C/15	20/04/2023	19/04/2024
2	HVS-GSES/HVS-02	RDS/UM-02	TECH/CAL/2023/04.C/3/4	20/04/2023	19/04/2024

NAAQS – National Ambient Air Quality Standards (2009)  
BDL- Below detectable level

*Manoj Kumar*  
For HORIZON SERVICES



#### DISCLAIMER:

- Sample will be retained only for 15 days.
- Above results indicate to the parameters mentioned only.
- Liability limited till issue of test reports only.
- The test report shall not be produced for any legal identity or advertised without permission of lab.
- The effect of results relate only to the item tested.



Lab Approved by MoEF, New Delhi. (Valid till 05/02/2024)  
Lab NABL Accredited - Testing - Chemical Field (TC - 7064)

"Shree", K 3/4, S. No. 10, Erandawane Housing Society, Opposite Deenanath Mangeshkar Hospital, Pune 411 004.  
• Mobile : 7249867318, 8378018710 • Tel. : 020 - 25460202 • Email : kmn@hespl.co.in / md@hespl.co.in • www.hespl.co.in

### AMBIENT AIR QUALITY MONITORING ANALYSIS REPORT

Report No.	: HS/REP/23-24/15945
Dated	: 24/01/2024
Client	: M/S SHRI GURUDATT SUGARS LTD., TAKALIWADI
Site	: GAT NO.61/A, AKIWAT TAKALIWADI ROAD, TAKALIWADI, TAL-SHIROL, DIST-KOLHAPUR, PIN- 416108.
Sample Collected by	: M/S. GREENSAFE ENVIRO SERVICES

### RESULTS

SR. NO.	TEST DESCRIPTION	UNIT	READINGS	NAAQS STANDARDS	METHOD OF SAMPLING AND ANALYSIS
01	DATE OF SAMPLING	DD/MM/YY	18/01/2024		
02	TEST LOCATION		Near ETP		
03	TIME OF SAMPLING	Hrs	09:30-17:30		
04	TEMPERATURE (Max./Min)	Deg C	28/24		
05	RELATIVE HUMIDITY	% RH	63		
06	SAMPLING DURATION	Hrs	8		
07	PM <sub>10</sub>	µg/m <sup>3</sup>	64.00	≤100	IS 5182(part 23),2006
08	PM <sub>2.5</sub>	µg/m <sup>3</sup>	31.00	≤60	CPCB Guidelines Volume – I Pg. No.15
09	SO <sub>2</sub>	µg/m <sup>3</sup>	6.60	≤80	IS 5182(part 2),2001, RA 2006
10	NO <sub>2</sub>	µg/m <sup>3</sup>	26.20	≤80	IS 5182(part 6),2006

#### Calibrations details: -

Sr. No.	Instrument Name	Serial / Identification No.	Certificate No.	Last Calibrated on	Due Date
1	AFDS-GSES/ADS-03	RDS/FM-03	TECH/CAL/2023/04.C/16	20/04/2023	19/04/2024
2	HVS-GSES/HVS-03	RDS/UM-03	TECH/CAL/2023/04.C/5/6	20/04/2023	19/04/2024

NAAQS – National Ambient Air Quality Standards (2009)  
BDL- Below detectable level

*M. N. A. G. S. S.*  
For HORIZON SERVICES



#### DISCLAIMER:

- Sample will be retained only for 15 days.
- Above results indicate to the parameters mentioned only.
- Liability limited till issue of test reports only.
- The test report shall not be produced for any legal identity or advertised without permission of lab.
- The effect of results relate only to the item tested.



Lab Approved by MoEF, New Delhi. (Valid till 05/02/2024)  
Lab NABL Accredited - Testing - Chemical Field (TC - 7064)

"Shree", K 3/4, S. No. 10, Erandawane Housing Society, Opposite Deenanath Mangeshkar Hospital, Pune 411 004.  
• Mobile : 7249867318, 8378018710 • Tel. : 020 - 25460202 • Email : kmn@hespl.co.in / md@hespl.co.in • www.hespl.co.in

### STACK EMISSION MONITORING REPORT

Report No.	: HS/REP/23-24/15946
Dated	: 24/01/2024
Client	: M/S SHRI GURUDATT SUGARS LTD., TAKALIWADI
Site	: GAT NO.61/A, AKIWAT TAKALIWADI ROAD, TAKALIWADI, TAL-SHIROL, DIST-KOLHAPUR, PIN- 416108.
Sample Collected by	: M/S. GREENSAFE ENVIRO SERVICES

### RESULTS

SR. NO.	DESCRIPTION	UNIT	RESULT	LIMITS	Methods Used
01	DATE OF SAMPLING	DD/MM/YY	18/01/2024		
02	TEST LOCATION		Boiler 1 & 2 (Capacity-70 MT/Hr & 40 MT/Hr)		
03	TIME OF SAMPLING (00.00)	Hrs	10:00		
04	MATERIAL OF STACK		--		
05	STACK HEIGHT (AGL)	Mtr	65		
06	TYPE OF FUEL USED	--	Baggase		
07	FUEL CONSUMPTION	MT/Hr	55		
08	TYPE OF STACK		Round		
09	FLUE GAS TEMPERATURE	Deg C	151		
10	VELOCITY	M/Sec	7.70		
11	DIAMETER OF STACK	M	3.43		
12	GAS VOLUME	Nm <sup>3</sup> /Hr	180512.33		
13	PM	mg/Nm <sup>3</sup>	75.01	As per Consent	IS 11255 (Part 1)
14	SO <sub>2</sub>	Kg/Day	98.00	As per Consent	IS 11255 (Part 2)

#### Calibrations details: -

Sr. No.	Instrument Name	Serial / Identification No.	Certificate No.	Last Calibrated on	Due Date
1	GSES/SMK-01	SMK/IT-01	TECH/CAL/2023/04.C/7/8/9/10	20/04/2023	19/04/2024

*M. N. Algaonkar*  
For HORIZON SERVICES



#### DISCLAIMER:

- Sample will be retained only for 15 days.
- Above results indicate to the parameters mentioned only.
- Liability limited till issue of test reports only.
- The test report shall not be produced for any legal identity or advertised without permission of lab.
- The effect of results relate only to the item tested.



Lab Approved by MoEF, New Delhi. (Valid till 05/02/2024)  
Lab NABL Accredited - Testing - Chemical Field (TC - 7064)

"Shree", K 3/4, S. No. 10, Erandawane Housing Society, Opposite Deenanath Mangeshkar Hospital, Pune 411 004.  
• Mobile : 7249867318, 8378018710 • Tel. : 020 - 25460202 • Email : kmn@hespl.co.in / md@hespl.co.in • www.hespl.co.in

### STACK EMISSION MONITORING REPORT

Report No.	: HS/REP/23-24/15947
Dated	: 24/01/2024
Client	: M/S SHRI GURUDATT SUGARS LTD., TAKALIWADI
Site	: GAT NO.61/A, AKIWAT TAKALIWADI ROAD, TAKALIWADI, TAL-SHIROL, DIST-KOLHAPUR, PIN- 416108.
Sample Collected by	: M/S. GREENSAFE ENVIRO SERVICES

### RESULTS

SR. NO.	DESCRIPTION	UNIT	RESULT	LIMITS	Methods Used
01	DATE OF SAMPLING	DD/MM/YY	18/01/2024		
02	TEST LOCATION		Incinerator Boiler		
03	TIME OF SAMPLING (00.00)	Hrs	10:30		
04	MATERIAL OF STACK		--		
05	STACK HEIGHT	Mtr	82		
06	TYPE OF FUEL USED	--	Coal & Con. Spent Wash		
07	TYPE OF STACK		Round		
08	FLUE GAS TEMPERATURE	Deg C	191		
09	VELOCITY	M/Sec	8.78		
10	DIAMETER OF STACK	M	4.43		
11	GAS VOLUME	Nm <sup>3</sup> /Hr	312331.38		
12	PM	mg/Nm <sup>3</sup>	66.90	150	IS 11255 (Part 1)
13	SO <sub>2</sub>	Kg/Day	112.10	500	IS 11255 (Part 2)

Calibrations details: -

Sr. No.	Instrument Name	Serial / Identification No.	Certificate No.	Last Calibrated on	Due Date
1	GSES/SMK-01	SMK/IT-01	TECH/CAL/2023/04.C/7/8/9/10	20/04/2023	19/04/2024

*kmn aegdekar*  
For HORIZON SERVICES



DISCLAIMER:

- Sample will be retained only for 15 days.
- Above results indicate to the parameters mentioned only.
- Liability limited till issue of test reports only.
- The test report shall not be produced for any legal identity or advertised without permission of lab.
- The effect of results relate only to the item tested.



Lab Approved by MoEF, New Delhi. (Valid till 05/02/2024)  
Lab NABL Accredited - Testing - Chemical Field (TC - 7064)

"Shree", K 3/4, S. No. 10, Erandawane Housing Society, Opposite Deenanath Mangeshkar Hospital, Pune 411 004.  
• Mobile : 7249867318, 8378018710 • Tel. : 020 - 25460202 • Email : kmn@hespl.co.in / md@hespl.co.in • www.hespl.co.in

### AMBIENT NOISE LEVEL MONITORING REPORT

Report No.	: HS/REP/23-24/15948
Dated	: 24/01/2024
Client	: M/S SHRI GURUDATT SUGARS LTD., TAKALIWADI
Site	: GAT NO.61/A, AKIWAT TAKALIWADI ROAD, TAKALIWADI, TAL-SHIROL, DIST-KOLHAPUR, PIN- 416108.
Sample Collected by	: M/S. GREENSAFE ENVIRO SERVICES
Date of Sampling	: 18/01/2024

### RESULTS

SR. NO.	TEST LOCATION	UNIT	DAY TIME		NIGHT TIME	
			Time	Readings	Time	Readings
01	Near Main Gate	dB (A)	11:00 hrs.	71.0	22:10 hrs.	66.2
02	Near Boiler	dB (A)	11:05 hrs.	69.4	22:15 hrs.	66.7
03	Near ETP Area	dB (A)	11:10 hrs.	67.9	22:20 hrs.	63.4
04	Near Sugar Godown	dB (A)	11:15 hrs.	72.0	22:25 hrs.	68.7
05	Near Laboratory	dB (A)	11:20 hrs.	73.3	22:30 hrs.	67.5
06	Near Mill House	dB (A)	11: 25 hrs.	72.9	23:35 hrs.	68.5
07	Near Pan Section	dB (A)	11:30 hrs.	73.0	23:40 hrs.	68.7
08	Near Sugar Plant	dB (A)	11:35 hrs.	72.7	23:45 hrs.	68.0
09	Near Weigh Bridge	dB (A)	11:40 hrs.	70.7	23:50 hrs.	66.4
10	Near Centrifugal	dB (A)	11:45 hrs.	72.0	23:55 hrs.	68.8

#### Calibrations details: -

Sr. No	Instrument Name	Serial / Identification No.	Certificate No.	Last Calibrated on	Due date
1	GSES/DB-01 Make- Mextech, MODEL NO.-4201	GE/DB-01	TECH/CAL/2023/04.C/11	20/04/2023	19/04/2024

#### Limits:

≤75 dB (A) For Day Time  
≤70 dB (A) For Night Time

#### REMARK/OBSERVATIONS:

Noise levels limits are given as per Noise Pollution (Regulation & Control) Rules 2010.

*M. V. Argalika*  
For HORIZON SERVICES



#### DISCLAIMER:

- Sample will be retained only for 15 days.
- Above results indicate to the parameters mentioned only.
- Liability limited till issue of test reports only.
- The test report shall not be produced for any legal identity or advertised without permission of lab.
- The effect of results relate only to the item tested.





Lab Approved by MoEF, New Delhi. (Valid till 05/02/2024)  
Lab NABL Accredited - Testing - Chemical Field (TC - 7064)

"Shree", K 3/4, S. No. 10, Erandawane Housing Society, Opposite Deenanath Mangeshkar Hospital, Pune 411 004.  
• Mobile : 7249867318, 8378018710 • Tel. : 020 - 25460202 • Email : kmn@hespl.co.in / md@hespl.co.in • www.hespl.co.in

### WORKZONE NOISE LEVEL MONITORING REPORT

Report No.	: HS/REP/23-24/15949
Dated	: 24/01/2024
Client	: M/S SHRI GURUDATT SUGARS LTD., TAKALIWADI
Site	: GAT NO.61/A, AKIWAT TAKALIWADI ROAD, TAKALIWADI, TAL-SHIROL, DIST-KOLHAPUR, PIN- 416108.
Sample Collected by	: M/S. GREENSAFE ENVIRO SERVICES
Date of Sampling	: 18/01/2024

### RESULTS

SR. NO.	TEST LOCATION	UNIT	DAY TIME	
			Time	Readings
01	Boiler House	dB (A)	13:00 hrs.	85.1
02	Laboratory	dB (A)	13:10 hrs.	74.2
03	Mill House	dB (A)	13:15 hrs.	88.5
04	Pan Section	dB (A)	13:20 hrs.	87.4
05	Sugar Godown	dB (A)	13:25 hrs.	79.9
06	WTP	dB (A)	13:30 hrs	77.3
07	ETP	dB (A)	13:35 hrs	78.6
08	Weigh Bridge	dB (A)	13:40 hrs	88.9
09	Centrifugal	dB (A)	13:45 hrs	83.6

Calibrations details: -

Sr. No	Instrument Name	Serial / Identification No.	Certificate No.	Last Calibrated on	Due date
1	GSES/DB-01 Make- Mextech, MODEL NO.-4201	GE/DB-01	TECH/CAL/2023/04.C/11	20/04/2023	19/04/2024

Limits:

In plant 90 dB (A)

### REMARKS/OBSERVATIONS:

Limits are given as per Maharashtra Factories Rules 1963 Schedule XXIV for 8 Hrs.

*M. N. G. G. G.*  
For HORIZON SERVICES



### DISCLAIMER:

- Sample will be retained only for 15 days.
- Above results indicate to the parameters mentioned only.
- Liability limited till issue of test reports only.
- The test report shall not be produced for any legal identity or advertised without permission of lab.
- The effect of results relate only to the item tested.



Lab Approved by MoEF, New Delhi. (Valid till 05/02/2024)  
Lab NABL Accredited - Testing - Chemical Field (TC - 7064)

"Shree", K 3/4, S. No. 10, Erandawane Housing Society, Opposite Deenanath Mangeshkar Hospital, Pune 411 004.  
• Mobile : 7249867318, 8378018710 • Tel. : 020 - 25460202 • Email : kmn@hespl.co.in / md@hespl.co.in • www.hespl.co.in

### ILLUMINATION MONITORING REPORT

Report No.	: HS/REP/23-24/15950
Dated	: 24/01/2024
Client	: M/S SHRI GURUDATT SUGARS LTD., TAKALIWADI
Site	: GAT NO.61/A, AKIWAT TAKALIWADI ROAD, TAKALIWADI, TAL-SHIROL, DIST-KOLHAPUR, PIN- 416108.
Sample Collected by	: M/S. GREENSAFE ENVIRO SERVICES
Date of Sampling	: 18/01/2024

### RESULTS

SR. NO.	DESCRIPTION OF PARAMETERS	UNIT	RESULT	MINIMUM LUX LEVEL REQUIRED
	<b>TEST LOCATIONS</b>			
01	Boiler House	Lux	940	300
02	Laboratory	Lux	789	450
03	Mill House	Lux	948	200
04	Pan Section	Lux	898	500
05	Sugar Godown	Lux	787	500
06	Office	Lux	980	300
07	Near Main Gate	Lux	790	200
08	Store	Lux	462	100
09	WTP	Lux	810	500
10	Laboratory (WTP)	Lux	764	450

Calibrations details: -

Sr. No	Instrument Name	Serial / Identification No.	Certificate No.	Last Calibrated on	Due date
1	LUX METER, GSES-LX-01 MAKE-Mextexh	LX-01	TECH/CAL/2023/04. C/12	20/04/2023	19/04/2024

*M. N. G. K. K.*  
For HORIZON SERVICES



**DISCLAIMER:**

- Sample will be retained only for 15 days.
- Above results indicate to the parameters mentioned only.
- Liability limited till issue of test reports only.
- The test report shall not be produced for any legal identity or advertised without permission of lab.
- The effect of results relate only to the item tested.



Lab Approved by MoEF, New Delhi. (Valid till 05/02/2024)  
Lab NABL Accredited - Testing - Chemical Field (TC - 7064)

"Shree", K 3/4, S. No. 10, Erandawane Housing Society, Opposite Deenanath Mangeshkar Hospital, Pune 411 004.  
• Mobile : 7249867318, 8378018710 • Tel. : 020 - 25460202 • Email : kmn@hespl.co.in / md@hespl.co.in • www.hespl.co.in

### ANALYSIS REPORT

F/LAB/04/01/17.12.2012

CLIENT'S NAME & ADDRESS	REPORT NO	HS/LAB/WA/15978A-1
M/s Shri Gurudatt Sugars Ltd., (Takaliwadi) Gat No.61/A, Akiwat Takaliwadi Road, Takaliwadi, Tal-Shirol, Dist -Kolhapur, Pin- 416108.	REPORT DATE	24/01/2024
	LAB REFERENCE NO.	HS/LAB/WA/1418A
	SAMPLING DATE	18/01/2024
	SAMPLE RECEIPT DATE	19/01/2024

DETAILS OF SAMPLE	SAMPLE COLLECTED BY	NATURE	LOCATION
Industrial Waste Water	M/s. Greensafe Enviro Services	Untreated	ETP

### RESULTS OF ANALYSIS

SR NO	DESCRIPTION	UNIT	RESULT	TEST METHOD
1	pH	---	4.40	APHA 24 <sup>th</sup> Ed 2023, 4500-H <sup>+</sup> B
2	Total Suspended Solids	mg/lit	360.00	APHA 24 <sup>th</sup> Ed 2023, 2540 D
3	Total Dissolved Solids	mg/lit	2478.00	APHA 24 <sup>th</sup> Ed 2023, 2540 C
4	Chemical Oxygen Demand	mg/lit	3860.00	APHA 24 <sup>th</sup> Ed 2023, 5220 C
5	Biochemical Oxygen Demand (27°C for 3 days)	mg/lit	1840.00	IS-3025 (Part 44) R-2023
6	Chlorides as Cl <sup>-</sup>	mg/lit	490.00	APHA 24 <sup>th</sup> Ed 2023, 4500 Cl <sup>-</sup> B
7	Sulphates as SO <sub>4</sub> --	mg/lit	762.00	APHA 24 <sup>th</sup> Ed 2023, 4500 SO <sub>4</sub> E
8	Oil & Grease	mg/lit	24.00	APHA 24 <sup>th</sup> Ed 2023, 5520 B



For HORIZON SERVICES

*Munaliwara*  
(LAB INCHARGE)

#### DISCLAIMER:

- Sample will be retained only for 15 days.
- Above results indicate to the parameters mentioned only.
- Liability limited till issue of test reports only.
- The test report shall not be produced for any legal identity or advertised without permission of lab.
- The effect of results relate only to the item tested.



Lab Approved by MoEF, New Delhi. (Valid till 05/02/2024)  
Lab NABL Accredited - Testing - Chemical Field (TC - 7064)

"Shree", K 3/4, S. No. 10, Erandawane Housing Society, Opposite Deenanath Mangeshkar Hospital, Pune 411 004.  
• Mobile : 7249867318, 8378018710 • Tel. : 020 - 25460202 • Email : kmn@hespl.co.in / md@hespl.co.in • www.hespl.co.in

### ANALYSIS REPORT

F/LAB/04/01/17.12.2012

CLIENT'S NAME & ADDRESS	REPORT NO	HS/LAB/WA/15978A-2
M/s Shri Gurudatt Sugars Ltd., (Takaliwadi) Gat No.61/A, Akiwat Takaliwadi Road, Takaliwadi, Tal-Shirol, Dist -Kolhapur, Pin- 416108.	REPORT DATE	24/01/2024
	LAB REFERENCE NO.	HS/LAB/WA/1418A
	SAMPLING DATE	18/01/2024
	SAMPLE RECEIPT DATE	19/01/2024

DETAILS OF SAMPLE	SAMPLE COLLECTED BY	NATURE	LOCATION
Industrial Waste Water	M/s. Greensafe Enviro Services	Treated	ETP

### RESULTS OF ANALYSIS

SR NO	DESCRIPTION	UNIT	RESULT	MPCB LIMITS	TEST METHOD
1	pH	---	7.10	5.5-9.0	APHA 24 <sup>th</sup> Ed 2023, 4500-H+B
2	Total Suspended Solids	mg/lit	68.00	< 100.00	APHA 24 <sup>th</sup> Ed 2023, 2540 D
3	Total Dissolved Solids	mg/lit	1604.00	< 2100.00	APHA 24 <sup>th</sup> Ed 2023, 2540 C
4	Chemical Oxygen Demand	mg/lit	164.00	< 250.00	APHA 24 <sup>th</sup> Ed 2023, 5220 C
5	Biochemical Oxygen Demand (27°C for 3 days)	mg/lit	54.00	< 100.00	IS-3025 (Part 44) R-2023
6	Chlorides as Cl <sup>-</sup>	mg/lit	304.00	< 600.00	APHA 24 <sup>th</sup> Ed 2023, 4500 Cl-B
7	Sulphates as SO <sub>4</sub> <sup>--</sup>	mg/lit	570.00	< 1000.00	APHA 24 <sup>th</sup> Ed 2023, 4500 SO <sub>4</sub> E
8	Oil & Grease	mg/lit	< 5.00	< 10.00	APHA 24 <sup>th</sup> Ed 2023, 5520 B



For HORIZON SERVICES

*Munag Deka*  
(LAB INCHARGE)

**DISCLAIMER:**

- Sample will be retained only for 15 days.
- Above results indicate to the parameters mentioned only.
- Liability limited till issue of test reports only.
- The test report shall not be produced for any legal identity or advertised without permission of lab.
- The effect of results relate only to the item tested.



Lab Approved by MoEF, New Delhi. (Valid till 05/02/2024)

"Shree", K 3/4, S. No. 10, Erandawane Housing Society, Opposite Deenanath Mangeshkar Hospital, Pune 411 004.  
• Tel.: 020 - 25460202, 25460203, 25460023, 25460033. • Email : kmn@hespl.co.in / md@hespl.co.in • www.hespl.co.in

## ANALYSIS REPORT

F/LAB/04/01/17.12.2012

<b>CLIENT'S NAME &amp; ADDRESS</b>	<b>REPORT NO</b>	HS/LAB/WA/17755A-1
<b>M/s Shri Gurudatt Sugars Ltd., (Takaliwadi)</b> Gat No.61/A, Akiwat Takaliwadi Road, Takaliwadi, Tal-Shirol, Dist -Kolhapur, Pin- 416108.	<b>REPORT DATE</b>	24/02/2024
	<b>LAB REFERENCE NO.</b>	HS/LAB/WA/1435A
	<b>SAMPLING DATE</b>	19/02/2024
	<b>SAMPLE RECEIPT DATE</b>	20/02/2024

<b>DETAILS OF SAMPLE</b>	<b>SAMPLE COLLECTED BY</b>	<b>NATURE</b>	<b>LOCATION</b>
Industrial Waste Water	M/s. Greensafe Enviro Services	Untreated	ETP

## RESULTS OF ANALYSIS

SR NO	DESCRIPTION	UNIT	RESULT	TEST METHOD
1	pH	---	4.60	APHA 24 <sup>th</sup> Ed 2023, 4500-H <sup>+</sup> B
2	Total Suspended Solids	mg/lit	410.00	APHA 24 <sup>th</sup> Ed 2023, 2540 D
3	Total Dissolved Solids	mg/lit	2490.00	APHA 24 <sup>th</sup> Ed 2023, 2540 C
4	Chemical Oxygen Demand	mg/lit	3894.00	APHA 24 <sup>th</sup> Ed 2023, 5220 C
5	Biochemical Oxygen Demand (27°C for 3 days)	mg/lit	2049.40	IS-3025 (Part 44) R-2023
6	Chlorides as Cl <sup>-</sup>	mg/lit	496.00	APHA 24 <sup>th</sup> Ed 2023, 4500 Cl <sup>-</sup> B
7	Sulphates as SO <sub>4</sub> <sup>--</sup>	mg/lit	784.00	APHA 24 <sup>th</sup> Ed 2023, 4500 SO <sub>4</sub> E
8	Oil & Grease	mg/lit	28.00	APHA 24 <sup>th</sup> Ed 2023, 5520 B



For **HORIZON SERVICES**

*M. N. Angolkar*

**(LAB INCHARGE)**



Lab Approved by MoEF, New Delhi. (Valid till 05/02/2024)

"Shree", K 3/4, S. No. 10, Erandawane Housing Society, Opposite Deenanath Mangeshkar Hospital, Pune 411 004.  
• Tel.: 020 - 25460202, 25460203, 25460023, 25460033. • Email : kmn@hespl.co.in / md@hespl.co.in • www.hespl.co.in

## ANALYSIS REPORT

F/LAB/04/01/17.12.2012

CLIENT'S NAME & ADDRESS	REPORT NO	HS/LAB/WA/17755A-2
M/s Shri Gurudatt Sugars Ltd., (Takaliwadi) Gat No.61/A, Akiwat Takaliwadi Road, Takaliwadi, Tal-Shirol, Dist -Kolhapur, Pin- 416108.	REPORT DATE	24/02/2024
	LAB REFERENCE NO.	HS/LAB/WA/1435A
	SAMPLING DATE	19/02/2024
	SAMPLE RECEIPT DATE	20/02/2024

DETAILS OF SAMPLE	SAMPLE COLLECTED BY	NATURE	LOCATION
Industrial Waste Water	M/s. Greensafe Enviro Services	Treated	ETP

## RESULTS OF ANALYSIS

SR NO	DESCRIPTION	UNIT	RESULT	MPCB LIMITS	TEST METHOD
1	pH	---	6.56	5.5-9.0	APHA 24 <sup>th</sup> Ed 2023, 4500-H <sup>+</sup> B
2	Total Suspended Solids	mg/lit	53.90	< 100.00	APHA 24 <sup>th</sup> Ed 2023, 2540 D
3	Total Dissolved Solids	mg/lit	1978.00	< 2100.00	APHA 24 <sup>th</sup> Ed 2023, 2540 C
4	Chemical Oxygen Demand	mg/lit	86.20	< 250.00	APHA 24 <sup>th</sup> Ed 2023, 5220 C
5	Biochemical Oxygen Demand (27°C for 3 days)	mg/lit	42.30	< 100.00	IS-3025 (Part 44) R-2023
6	Chlorides as Cl <sup>-</sup>	mg/lit	128.00	< 600.00	APHA 24 <sup>th</sup> Ed 2023, 4500 Cl <sup>-</sup> B
7	Sulphates as SO <sub>4</sub> <sup>--</sup>	mg/lit	310.00	< 1000.00	APHA 24 <sup>th</sup> Ed 2023, 4500 SO <sub>4</sub> E
8	Oil & Grease	mg/lit	5.00	< 10.00	APHA 24 <sup>th</sup> Ed 2023, 5520 B



For **HORIZON SERVICES**

*M. N. Angolkar*

**(LAB INCHARGE)**



Lab Approved by MoEF, New Delhi. (Valid till 05/02/2024)

"Shree", K 3/4, S. No. 10, Erandawane Housing Society, Opposite Deenanath Mangeshkar Hospital, Pune 411 004.  
• Tel.: 020 - 25460202, 25460203, 25460023, 25460033. • Email : kmn@hespl.co.in / md@hespl.co.in • www.hespl.co.in

## ANALYSIS REPORT

F/LAB/04/01/17.12.2012

<b>CLIENT'S NAME &amp; ADDRESS</b>	<b>REPORT NO</b>	HS/LAB/WA/17755A-3
<b>M/s.Shri Gurudatt Sugars Ltd., (Takaliwadi)</b> Gat No.61/A, Akiwat Takaliwadi Road, Takaliwadi, Tal-Shirol, Dist –Kolhapur, Pin- 416108.	<b>REPORT DATE</b>	24/02/2024
	<b>LAB REFERENCE NO</b>	HS/LAB/WA/1435A
	<b>DATE OF SAMPLING</b>	19/02/2024
	<b>DATE OF ANALYSIS</b>	20/02/2024

DETAILS OF SAMPLE	SAMPLE COLLECTED BY	NATURE	LOCATION
Well Water Sample	M/s. Greensafe Enviro Services	---	Shri Gurupad Borgave

## RESULTS OF ANALYSIS

SR NO	DESCRIPTION	UNIT	RESULT	LIMITS AS PER IS10500: 2012 (RA 2018)	TEST METHOD
01	pH	---	7.17	6.5 – 8.5	APHA 24 <sup>th</sup> Ed 2023, 4500-H <sup>+</sup> B
02	Electric Conductivity	µs/cm	300.00	Not Specified	APHA 24 <sup>th</sup> Ed 2023, 2510 B
03	Colour	Pt/Co	< 5.00	<5.00	APHA 24 <sup>th</sup> Ed 2023, 2120 C
04	Odour	---	Agreeable	Agreeable	IS 3025 (P-5):1983 RA 2022
05	Turbidity	NTU	0.80	<1.00	APHA 24 <sup>th</sup> Ed 2023, 2130 B
06	Total Dissolved Solids	mg/lit	220.00	<500.00	APHA 24 <sup>th</sup> Ed 2023, 2540 C
07	Chemical Oxygen Demand	mg/lit	12.00	Not Specified	APHA 24 <sup>th</sup> Ed 2023, 5220 C
08	Biochemical Oxygen Demand (27°C for 3 days)	mg/lit	4.00	Not Specified	IS 3025 (Part 44)- R-2023
09	Chlorides as Cl <sup>-</sup>	mg/lit	28.00	<250.00	APHA 24 <sup>th</sup> Ed 2023, 4500 Cl-B
10	Sulphates as SO <sub>4</sub> --	mg/lit	40.00	<200.00	APHA 24 <sup>th</sup> Ed 2023, 4500 SO <sub>4</sub> E
11	Alkalinity as CaCO <sub>3</sub>	mg/lit	38.00	<200.00	APHA 24 <sup>th</sup> Ed 2023, 2320 B
12	Calcium as Ca	mg/lit	20.00	<75.00	APHA 24 <sup>th</sup> Ed 2023, 3500 Ca B
13	Magnesium as Mg	mg/lit	10.00	<30.00	APHA 24 <sup>th</sup> Ed 2023, 3500 Mg B
14	Total Hardness as CaCO <sub>3</sub>	mg/lit	90.00	<200.00	APHA 24 <sup>th</sup> Ed 2023, 2340 C
15	Iron as Fe	mg/lit	0.18	<0.30	APHA 24 <sup>th</sup> Ed 2023, 3500 Fe B
16	Fluoride as F <sup>-</sup>	mg/lit	0.10	<1.00	APHA 24 <sup>th</sup> Ed 2023, 4500-F <sup>-</sup> D
17	Sodium as Na	mg/lit	2.10	Not Specified	APHA 24 <sup>th</sup> Ed 2023, 3500 Na B

**REMARK:** As per IS 10500: 2012(RA 2018), above water sample is chemically potable for drinking purpose, for the parameters tested.

For **HORIZON SERVICES**



*M. N. Angolkar*

**(LAB INCHARGE)**



Lab Approved by MoEF, New Delhi. (Valid till 05/02/2024)

"Shree", K 3/4, S. No. 10, Erandawane Housing Society, Opposite Deenanath Mangeshkar Hospital, Pune 411 004.  
• Tel.: 020 - 25460202, 25460203, 25460023, 25460033. • Email : kmn@hespl.co.in / md@hespl.co.in • www.hespl.co.in

## ANALYSIS REPORT

F/LAB/04/01/17.12.2012

<b>CLIENT'S NAME &amp; ADDRESS</b>	<b>REPORT NO</b>	HS/LAB/WA/17755A-4
<b>M/s Shri Gurudatt Sugars Ltd., (Takaliwadi)</b> Gat No.61/A, Akiwat Takaliwadi Road, Takaliwadi, Tal-Shirol, Dist –Kolhapur, Pin- 416108.	<b>REPORT DATE</b>	24/02/2024
	<b>LAB REFERENCE NO</b>	HS/LAB/WA/1435A
	<b>DATE OF SAMPLING</b>	19/02/2024
	<b>DATE OF ANALYSIS</b>	20/02/2024

DETAILS OF SAMPLE	SAMPLE COLLECTED BY	NATURE	LOCATION
Soil Sample	M/s. Greensafe Enviro Services	---	Shri Raosaheb Badame

## RESULTS OF ANALYSIS

SR NO	DESCRIPTION	UNIT	RESULT	TEST METHOD
1	pH (10 % Extract)	---	7.22	IS 2720 (Part 26) 1987 RA 2016
2	Chlorides as Cl <sup>-</sup>	mg/kg	172.00	SOP NO: HS/ NABL/ SOIL/27
3	Sulphates as SO <sub>4</sub> <sup>--</sup>	mg/kg	ABSENT	IS 2720 (Part 27)- 2020
4	Total Chromium as Cr	mg/kg	20.00	SOP NO: HS/ NABL/ SOIL/20
5	Total Nitrogen as N	mg/kg	138.00	IS 14684:2019
6	Phosphorus as P	mg/kg	ABSENT	SOP NO: HS/ NABL/ SOIL/08
7	Nickel as Ni	mg/kg	34.00	SOP NO: HS/ NABL/ SOIL/20
8	Cadmium as Cd	mg/kg	0.30	SOP NO: HS/ NABL/ SOIL/20
9	Copper as Cu	mg/kg	38.00	SOP NO: HS/ NABL/ SOIL/26
10	Zinc as Zn	mg/kg	20.00	SOP NO: HS/ NABL/ SOIL/20
11	Total Ammonia as N	mg/kg	ABSENT	Ministry of Agriculture 2011



For **HORIZON SERVICES**

*M. N. Angolkar*

**(LAB INCHARGE)**





Lab Approved by MoEF, New Delhi. (Valid till 05/02/2024)

"Shree", K 3/4, S. No. 10, Erandawane Housing Society, Opposite Deenanath Mangeshkar Hospital, Pune 411 004.  
• Tel.: 020 - 25460202, 25460203, 25460023, 25460033. • Email : kmn@hespl.co.in / md@hespl.co.in • www.hespl.co.in

## ANALYSIS REPORT

F/LAB/04/01/17.12.2012

<b>CLIENT'S NAME &amp; ADDRESS</b> M/s Shri Gurudatt Sugars Ltd., (Takaliwadi) Gat No.61/A, Akiwat Takaliwadi Road, Takaliwadi, Tal-Shirol, Dist -Kolhapur, Pin- 416108.	<b>REPORT NO</b>	HS/LAB/WA/17755A-5
	<b>REPORT DATE</b>	24/02/2024
	<b>LAB REFERENCE NO.</b>	HS/LAB/WA/1435A
	<b>SAMPLING DATE</b>	19/02/2024
	<b>SAMPLE RECEIPT DATE</b>	20/02/2024

<b>DETAILS OF SAMPLE</b>	<b>SAMPLE COLLECTED BY</b>	<b>NATURE</b>	<b>LOCATION</b>
Industrial Waste Water	M/s. Greensafe Enviro Services	---	RO Plant

## RESULTS OF ANALYSIS

<b>SR NO</b>	<b>DESCRIPTION</b>	<b>UNIT</b>	<b>RESULT</b>	<b>TEST METHOD</b>
1	pH	---	7.30	APHA 24 <sup>th</sup> Ed 2023, 4500-H <sup>+</sup> B
2	Total Suspended Solids	mg/lit	74.00	APHA 24 <sup>th</sup> Ed 2023, 2540 D
3	Chemical Oxygen Demand	mg/lit	NIL	APHA 24 <sup>th</sup> Ed 2023, 5220 C
4	Biochemical Oxygen Demand (27°C for 3 days)	mg/lit	NIL	IS-3025 (Part 44) R-2023



For **HORIZON SERVICES**

*M. N. Agarkar*

**(LAB INCHARGE)**



Lab Approved by MoEF, New Delhi. (Valid till 05/02/2024)

"Shree", K 3/4, S. No. 10, Erandawane Housing Society, Opposite Deenanath Mangeshkar Hospital, Pune 411 004.  
• Tel.: 020 - 25460202, 25460203, 25460023, 25460033. • Email : kmn@hespl.co.in / md@hespl.co.in • www.hespl.co.in

## ANALYSIS REPORT

F/LAB/04/01/17.12.2012

<b>CLIENT'S NAME &amp; ADDRESS</b>	<b>REPORT NO</b>	HS/LAB/WA/17755A-6
<b>M/s.Shri Gurudatt Sugars Ltd., (Takaliwadi)</b> Gat No.61/A, Akiwat Takaliwadi Road, Takaliwadi, Tal-Shirol, Dist –Kolhapur, Pin- 416108.	<b>REPORT DATE</b>	24/02/2024
	<b>LAB REFERENCE NO</b>	HS/LAB/WA/1435A
	<b>DATE OF SAMPLING</b>	19/02/2024
	<b>DATE OF ANALYSIS</b>	20/02/2024

DETAILS OF SAMPLE	SAMPLE COLLECTED BY	NATURE	LOCATION
Well Water Sample	M/s. Greensafe Enviro Services	---	Ramchandra Bedkihale

## RESULTS OF ANALYSIS

SR NO	DESCRIPTION	UNIT	RESULT	LIMITS AS PER IS10500: 2012 (RA 20180)	TEST METHOD
01	pH	---	7.10	6.5 – 8.5	APHA 24 <sup>th</sup> Ed 2023, 4500-H <sup>+</sup> B
02	Electric Conductivity	µs/cm	320.00	Not Specified	APHA 24 <sup>th</sup> Ed 2023, 2510 B
03	Colour	Pt/Co	< 5.00	<5.00	APHA 24 <sup>th</sup> Ed 2023, 2120 C
04	Odour	---	Agreeable	Agreeable	IS 3025 (P-5):1983 RA 2022
05	Turbidity	NTU	0.62	<1.00	APHA 24 <sup>th</sup> Ed 2023, 2130 B
06	Total Dissolved Solids	mg/lit	232.00	<500.00	APHA 24 <sup>th</sup> Ed 2023, 2540 C
07	Chemical Oxygen Demand	mg/lit	8.00	Not Specified	APHA 24 <sup>th</sup> Ed 2023, 5220 C
08	Biochemical Oxygen Demand (27°C for 3 days)	mg/lit	2.00	Not Specified	IS 3025 (Part 44)- R-2023
09	Chlorides as Cl <sup>-</sup>	mg/lit	20.00	<250.00	APHA 24 <sup>th</sup> Ed 2023, 4500 Cl-B
10	Sulphates as SO <sub>4</sub> --	mg/lit	30.00	<200.00	APHA 24 <sup>th</sup> Ed 2023, 4500 SO <sub>4</sub> E
11	Alkalinity as CaCO <sub>3</sub>	mg/lit	32.00	<200.00	APHA 24 <sup>th</sup> Ed 2023, 2320 B
12	Calcium as Ca	mg/lit	24.00	<75.00	APHA 24 <sup>th</sup> Ed 2023, 3500 Ca B
13	Magnesium as Mg	mg/lit	12.00	<30.00	APHA 24 <sup>th</sup> Ed 2023, 3500 Mg B
14	Total Hardness as CaCO <sub>3</sub>	mg/lit	108.00	<200.00	APHA 24 <sup>th</sup> Ed 2023, 2340 C
15	Iron as Fe	mg/lit	0.10	<0.30	APHA 24 <sup>th</sup> Ed 2023, 3500 Fe B
16	Fluoride as F <sup>-</sup>	mg/lit	0.10	<1.00	APHA 24 <sup>th</sup> Ed 2023, 4500-F D
17	Sodium as Na	mg/lit	2.14	Not Specified	APHA 24 <sup>th</sup> Ed 2023, 3500 Na B

**REMARK:** As per IS 10500: 2012(RA 2018), above water sample is chemically potable for drinking purpose, for the parameters tested.

For **HORIZON SERVICES**



*M. N. Angolkar*

**(LAB INCHARGE)**



Lab Approved by MoEF, New Delhi. (Valid till 05/02/2024)  
Lab NABL Accredited - Testing - Chemical Field (TC - 7064)

"Shree", K 3/4, S. No. 10, Erandawane Housing Society, Opposite Deenanath Mangeshkar Hospital, Pune 411 004.  
• Mobile : 7249867318, 8378018710 • Tel. : 020 - 25460202 • Email : kmn@hespl.co.in / md@hespl.co.in • www.hespl.co.in

### ANALYSIS REPORT

F/LAB/04/01/17.12.2012

CLIENT'S NAME & ADDRESS	REPORT NO	HS/LAB/WA/15978A-3
M/s.Shri Gurudatt Sugars Ltd., (Takaliwadi) Gat No.61/A, Akiwat Takaliwadi Road, Takaliwadi, Tal-Shirol, Dist -Kolhapur, Pin- 416108.	REPORT DATE	24/01/2024
	LAB REFERENCE NO	HS/LAB/WA/1418A
	DATE OF SAMPLING	18/01/2024
	DATE OF ANALYSIS	19/01/2024

DETAILS OF SAMPLE	SAMPLE COLLECTED BY	NATURE	LOCATION
Well Water Sample	M/s. Greensafe Enviro Services	---	Shri Gurupad Borgave

### RESULTS OF ANALYSIS

SR NO	DESCRIPTION	UNIT	RESULT	LIMITS AS PER IS10500: 2018	TEST METHOD
01	pH	---	7.20	6.5 - 8.5	APHA 24 <sup>th</sup> Ed 2023, 4500-H*B
02	Electric Conductivity	µs/cm	130.00	Not Specified	APHA 24 <sup>th</sup> Ed 2023, 2510 B
03	Colour	Hazen	< 5.00	<5.00	APHA 24 <sup>th</sup> Ed 2023, 2120 C
04	Odour	---	Agreeable	Agreeable	APHA 24 <sup>th</sup> Ed 2023, 2150 B
05	Turbidity	NTU	<1.00	<1.00	APHA 24 <sup>th</sup> Ed 2023, 2130 B
06	Total Dissolved Solids	mg/lit	114.00	<500.00	APHA 24 <sup>th</sup> Ed 2023, 2540 C
07	Chemical Oxygen Demand	mg/lit	4.00	Not Specified	APHA 24 <sup>th</sup> Ed 2023, 5220 C
08	Biochemical Oxygen Demand (27°C for 3 days)	mg/lit	1.00	Not Specified	IS 3025 (Part 44)- R-2023
09	Chlorides as Cl <sup>-</sup>	mg/lit	24.00	<250.00	APHA 24 <sup>th</sup> Ed 2023, 4500 Cl-B
10	Sulphates as SO <sub>4</sub> <sup>--</sup>	mg/lit	46.00	<200.00	APHA 24 <sup>th</sup> Ed 2023, 4500 SO4 E
11	Alkalinity as CaCO <sub>3</sub>	mg/lit	35.00	<200.00	APHA 24 <sup>th</sup> Ed 2023, 2320 B
12	Calcium as Ca	mg/lit	12.00	<75.00	APHA 24 <sup>th</sup> Ed 2023, 3500 Ca B
13	Magnesium as Mg	mg/lit	8.00	<30.00	APHA 24 <sup>th</sup> Ed 2023, 3500 Mg B
14	Total Hardness as CaCO <sub>3</sub>	mg/lit	118.00	<200.00	APHA 24 <sup>th</sup> Ed 2023, 2340 C
15	Iron as Fe	mg/lit	0.20	<0.30	APHA 24 <sup>th</sup> Ed 2023, 3500 Fe B
16	Fluoride as F <sup>-</sup>	mg/lit	<0.10	<1.00	APHA 24 <sup>th</sup> Ed 2023, 4500-F- D
17	Sodium as Na	mg/lit	2.00	Not Specified	APHA 24 <sup>th</sup> Ed 2023, 3500 Na B

**REMARK:** As per IS 10500: 2018, above water sample is chemically potable for drinking purpose, for the parameters tested.



For HORIZON SERVICES

*M. N. Gaikwad*  
(LAB INCHARGE)

#### DISCLAIMER:

- Sample will be retained only for 15 days.
- Above results indicate to the parameters mentioned only.
- Liability limited till issue of test reports only.
- The test report shall not be produced for any legal identity or advertised without permission of lab.
- The effect of results relate only to the item tested.



Lab Approved by MoEF, New Delhi. (Valid till 05/02/2024)  
Lab NABL Accredited - Testing - Chemical Field (TC - 7064)

"Shree", K 3/4, S. No. 10, Erandawane Housing Society, Opposite Deenanath Mangeshkar Hospital, Pune 411 004.  
• Mobile : 7249867318, 8378018710 • Tel. : 020 - 25460202 • Email : kmn@hespl.co.in / md@hespl.co.in • www.hespl.co.in

### ANALYSIS REPORT

F/LAB/04/01/17.12.2012

CLIENT'S NAME & ADDRESS	REPORT NO	HS/LAB/WA/15978A-4
M/s Shri Gurudatt Sugars Ltd., (Takaliwadi) Gat No.61/A, Akiwat Takaliwadi Road, Takaliwadi, Tal-Shirol, Dist -Kolhapur, Pin- 416108.	REPORT DATE	24/01/2024
	LAB REFERENCE NO	HS/LAB/WA/1418A
	DATE OF SAMPLING	18/01/2024
	DATE OF ANALYSIS	19/01/2024

DETAILS OF SAMPLE	SAMPLE COLLECTED BY	NATURE	LOCATION
Soil Sample	M/s. Greensafe Enviro Services	---	Shri Raosaheb Badame

### RESULTS OF ANALYSIS

SR NO	DESCRIPTION	UNIT	RESULT	TEST METHOD
1	pH (10 % Extract)	---	7.20	IS 2720 (Part 26) 1987
2	Chlorides as Cl <sup>-</sup>	mg/kg	168.00	SOP No: WI/Lab/Soil/CA/13
3	Sulphates as SO <sub>4</sub> <sup>--</sup>	mg/kg	ABSENT	IS 2720 (Part 27)- 1977 (RA 2010)
4	Total Chromium as Cr	mg/kg	16.00	Ministry of Agriculture 2011
5	Total Nitrogen as N	mg/kg	129.00	IS 14684:1999
6	Phosphorus as P	mg/kg	ABSENT	HS/NABL/SOIL/8
7	Nickel as Ni	mg/kg	26.00	Ministry of Agriculture 2011
8	Cadmium as Cd	mg/kg	0.40	Ministry of Agriculture 2011
9	Copper as Cu	mg/kg	34.00	Ministry of Agriculture 2011
10	Zinc as Zn	mg/kg	26.00	HS/NABL/SOIL/11
11	Total Ammonia as N	mg/kg	ABSENT	Ministry of Agriculture 2011



For HORIZON SERVICES

*M. Nagendra*

(LAB INCHARGE)

#### DISCLAIMER:

- Sample will be retained only for 15 days.
- Above results indicate to the parameters mentioned only.
- Liability limited till issue of test reports only.
- The test report shall not be produced for any legal identity or advertised without permission of lab.
- The effect of results relate only to the item tested.

# Condensate Polishing Unit

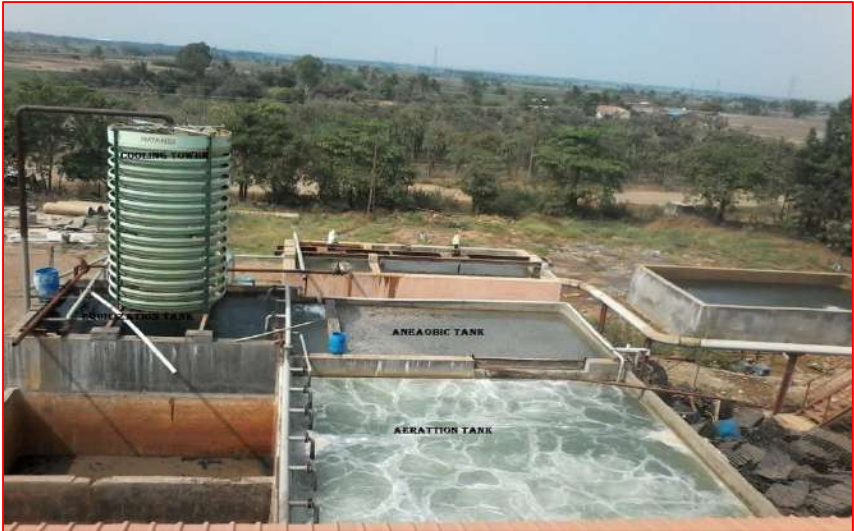

## Online Monitoring System at SGSL

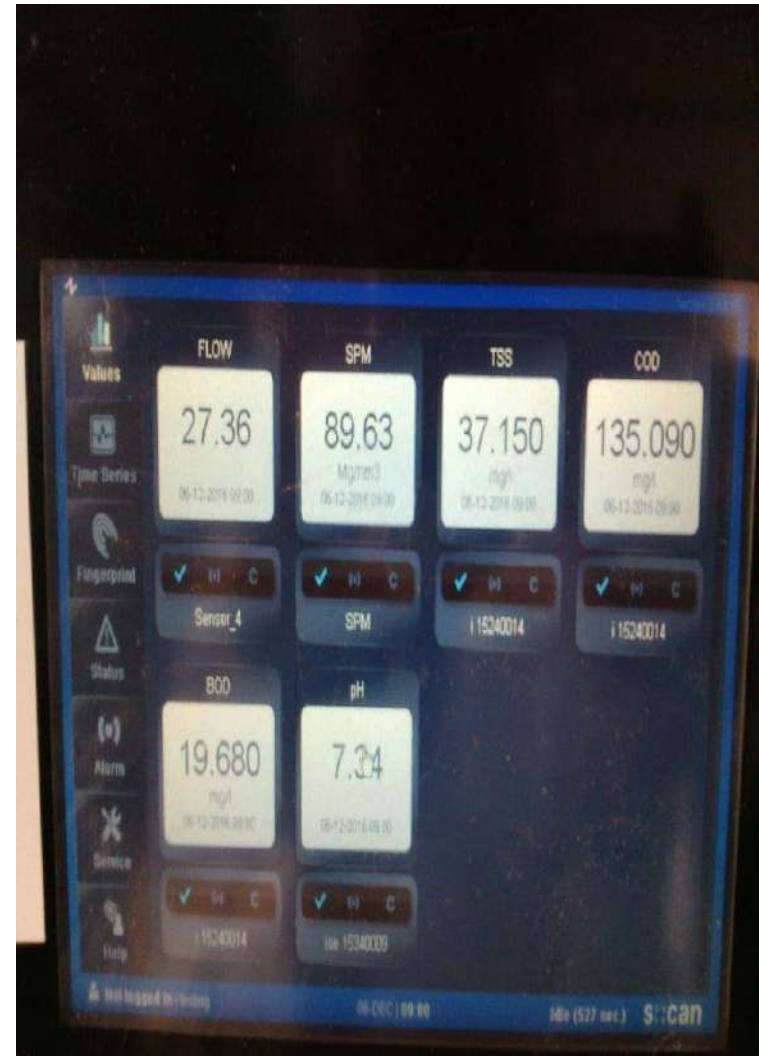



# SHRI GURUDATT SUGARS LIMITED

Gat No.61, Akiwat-Takaliwadi Road, Near Balumama Mandir,  
TAKALIWADI - 416 108 Tal.: Shirol, Dist.:Kolhapur (Maharashtra State)  
Reg. No. 25-14367, Tele Fax : (02322) 241577, 241877, 241977  
Ph. (0231) 2686086 Fax No. (0231) 2686000 E-mail : gsisugars@gmail.com

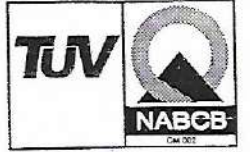

AN ISO 9001 : 2008  
Certified Company

**Shri. Bhagawanrao G. Ghatge**  
Founder  
**Shri. Madhavrao B. Ghatge**  
Chairman & Managing Director

Ref. No. राकजीएस/शिरोल/149/2017

Date : 26/03/2017

प्रति,  
मा.सरपंच / ग्रामसेवक  
मु.पो. टाकळीवाडी ता. शिरोळ  
जि. कोल्हापूर

विषय :- ना हरकत दाखला मिळणेबाबत ..

महोदय

आमचे श्री गुरुदत्त शुगर्स लि.टाकळीवाडी या कारखान्याच्या सध्या असलेल्या ४९०० मे.टन प्रतिदिन गाळप क्षमता व १५ मेगावॉट विजनिर्मिती प्रकल्पाची क्षमता विस्तारीकरण प्रतिदिन ६००० मे.टन उस गाळप व २१ मेगावॉट विजनिर्मिती करणेस central Pollution control Board ,Delhi.यांचेकडून दि.२०/०३/२०१७ च्या पत्राने मान्यता मिळाली आहे.

तरी सदरच्या वाढीव गाळप क्षमता व विजनिर्मिती प्रकल्पाचे विस्तारीकरणास आपल्या ग्रामपंचायतीचा ना हरकत दाखला मिळावा हि विनंती.

सोबत :- CPCB चे मंजूरीचे पत्र.

आपला विश्वासू

प्रेसीडेंट

श्री गुरुदत्त शुगर्स लि.टाकळीवाडी.

Received  
26/3/2017

ग्रामसेवक,  
ग्रामपंचायत टाकळीवाडी,  
ता. शिरोळ, जि. कोल्हापूर.



Regd. No. 25-14101 CIN-184309-SGSI-LTD

100% Wholly Owned Indian Company

# SHRI GURUDATT SUGARS LTD., Takaliwad.

ADD.: Gat No. : 61/A, Akiwat Takaliwadi Road, Takaliwadi Tal. - Shirol Dist - Kolhapur (MH) Pin Code : 416 10  
PHONE : +91 231 2686088 | FAX : +91 231 2686000 | WEBSITE : www.sgsl.co.in | Email : gsisugars@gmail.com

SGSL/ENV/ 1198 /2017-2018

Date - 31/03/2017

To,  
The Chief Executive Officer so,  
Zilha Parishad Office,  
Nagala Park, Kolhapur.

**Subject:** Submission of Environmental Clearance Copy for Shri Gurudatt Sugars Ltd. Gat No. 61/A. Akiwat Takaliwadi Road, Takaliwadi, Tal. Shirol, Dist. Kolhapur, Maharashtra.

**Ref:** MoEF & CC Letter No.F. No. -J- 11011/41 / 2015-IA-II (I) Dated 20.03.2017

Respected Sir,

With reference to above subject, we are submitting here with Environmental Clearance Copy of sugar manufacturing (from 4900 TCD to 6000 TCD, Co-generation capacity (15 MW to 21 MW) at Gat No. 61/A, Akiwat Takaliwadi Road, Tal. Shirol, Dist. Kolhapur, Maharashtra received from Ministry of Environment, Forest and Climate Change, New Delhi.

This is for your information please.

Thanking You.

Yours Faithfully

For, Shri Gurudatt Sugars Ltd.,

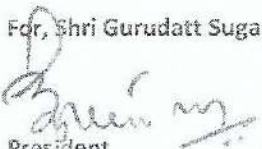
  
President

Copy -Enclosed above with copy of EC

  
5/3/2017  
11:45 AM  
11/3/2017  
11:45 AM



# जाहीर नोटीस

## श्री गुरुदत्त शुगर्स लिमिटेड टाकळीवाडी पर्यावरण विषयक अनुमती

श्री गुरुदत्त शुगर्स लिमिटेड, गट नं.६१/अ,  
अकिवाट टाकळीवाडी रोड, टाकळीवाडी, ता.शिरोळ,  
जि.कोल्हापूर पिन नं.४१६१०८ तर्फे कळविणेत येते  
की, आमच्या कारखान्यामध्ये गाळप क्षमता 4900 TCD  
ते 6000 TCD व सहविजनिर्मिती प्रकल्प 15MW ते 21  
MW वाढीव प्रकल्पास भारत सरकारचे पर्यावरण,  
वनविभाग व हवामान बदल, मंत्रालय, नवी दिल्ली कडील  
पत्र संदर्भ F. No. J-11011/41/2015-IA-II (I) दिनांक  
२०/३/२०१७ ने विस्तारीकरणास अनुमती मिळालेली  
आहे.

श्री. माधवराव भगवानराव घाटगे  
चेअरमन व कार्यकारी संचालक  
श्री गुरुदत्त शुगर्स लिमिटेड, टाकळीवाडी

बंधुता पेपर

## **PUBLIC NOTICE**

To whomsoever,  
it may concern

This is to inform to the public that Shri Gurudatt Sugars Ltd., Gat 61/A, Akiwat- Takaliwadi Road, Takaliwadi, Tal. Shirol, Dist. Kolhapur- 416108. Maharashtra has been granted Environmental Clearance for their proposed expansion of sugar plant 4900 TCD to 6000 TCD and Co-generation 15 MW to 21 MW vide letter No. F. No. J-11011/ 47/ 2015- [A-II(I), Dt. 20/03/2017.

The Copy of same can be viewed at website of ministry of Environment and forest and climate change of <http://moef.nic.in>

**-Shri Madhavrao B. Ghatge**  
Chairman &  
Managing Director





# Maharashtra Pollution Control Board

महाराष्ट्र प्रदूषण नियंत्रण मंडळ

## FORM V

(See Rule 14)

Environmental Audit Report for the financial Year ending the 31st March 2024

### Unique Application Number

MPCB-ENVIRONMENT\_STATEMENT-0000064684

### Submitted Date

12-04-2024

## PART A

### Company Information

#### Company Name

Shri Gurudatt Sugars Ltd.,

#### Application UAN number

MPCB-CONSENT-0000139930

#### Address

Gat No - 61/A, A/p - Takaliwadi

#### Plot no

Gat No. 61/A

#### Taluka

Shirol

#### Village

Akiwat -Takaliwadi Road

#### Capital Investment (In lakhs)

25691.00

#### Scale

L.S.I

#### City

Kolhapur

#### Pincode

416108

#### Person Name

Mr. Rahul Madhavrao Ghatage

#### Designation

Executive Directors

#### Telephone Number

7350799494

#### Fax Number

02312686086

#### Email

gslsugars.env@gmail.com

#### Region

SRO-Kolhapur

#### Industry Category

Red

#### Industry Type

R12 Sugar ( excluding Khandsari)

#### Last Environmental statement submitted online

yes

#### Consent Number

MPCB-CONSENT-0000139930

#### Consent Issue Date

2023-08-08

#### Consent Valid Upto

2024-07-31

#### Establishment Year

2002

#### Date of last environment statement submitted

Apr 6 2023 12:00:00:000AM

#### Industry Category Primary (STC Code) & Secondary (STC Code)

### Product Information

#### Product Name

Sugar

#### Consent Quantity

259200

#### Actual Quantity

74900.36

#### UOM

MT/A

Molasses

87816

29684.51

MT/A

Press Mud

87816

24729.14

MT/A

Bagasse

648000

182000.48

MT/A

Electric Power (Cogeneration)

21

17.52

Mwh

### By-product Information

#### By Product Name

NA

#### Consent Quantity

0

#### Actual Quantity

0

#### UOM

MT/A

## Part-B (Water & Raw Material Consumption)

### 1) Water Consumption in m3/day

Water Consumption for Process	Consent Quantity in m3/day	Actual Quantity in m3/day
Cooling	1100.00	1078.00
Domestic	475.00	459.00
All others	60.00	48.00
Total	0.00	0.00
	1635.00	1585.00

### 2) Effluent Generation in CMD / MLD

Particulars	Consent Quantity	Actual Quantity	UOM
Daily Quantity of Trade Effluent from the Factory	518	459	CMD

### 2) Product Wise Process Water Consumption (cubic meter of process water per unit of product)

Name of Products (Production)	During the Previous financial Year	During the current Financial year	UOM
Sugar (excluding Khandsari)	0.80	0.77	CMD
Sugar (excluding Khandsari)	0.56	0.54	CMD
Sugar (excluding Khandsari)	0.49	0.49	CMD
Sugar (excluding Khandsari)	0.53	0.52	CMD
Sugar (excluding Khandsari)	0.1	0.1	CMD

### 3) Raw Material Consumption (Consumption of raw material per unit of product)

Name of Raw Materials	During the Previous financial Year	During the current Financial year	UOM
Sugar Cane	7035474.240	660238.198	MT/A
Lime	1145	1103	MT/A
Sulphure	168.85	148.52	MT/A

### 4) Fuel Consumption

Fuel Name	Consent quantity	Actual Quantity	UOM
Bagasse	648000	184866.932	MT/A

## Part-C

### Pollution discharged to environment/unit of output (Parameter as specified in the consent issued)

#### [A] Water

Pollutants Detail	Quantity of Pollutants discharged (kL/day)	Concentration of Pollutants discharged (Mg/Lit) Except PH, Temp, Colour	Percentage of variation from prescribed standards with reasons	Standard	Reason
	Quantity	Concentration	%variation		
PH	14.52	0	0	0	0
COD	41.53	0	0	0	0
BOD	13.98	0	0	0	0

#### [B] Air (Stack)

<b>Pollutants Detail</b>	<b>Quantity of Pollutants discharged (kL/day)</b>	<b>Concentration of Pollutants discharged(Mg/NM3)</b>	<b>Percentage of variation from prescribed standards with reasons</b>	<b>Standard</b>	<b>Reason</b>
	<b>Quantity</b>	<b>Concentration</b>	<b>%variation</b>		
Total Particulate Matter	459.52	52.51	0	0	0

## Part-D

### **HAZARDOUS WASTES**

#### **1) From Process**

<b>Hazardous Waste Type</b>	<b>Total During Previous Financial year</b>	<b>Total During Current Financial year</b>	<b>UOM</b>
5.1 Used or spent oil	0.19	0.12	MT/A

#### **2) From Pollution Control Facilities**

<b>Hazardous Waste Type</b>	<b>Total During Previous Financial year</b>	<b>Total During Current Financial year</b>	<b>UOM</b>
5.1 Used or spent oil	0.19	0.12	MT/A

## Part-E

### **SOLID WASTES**

#### **1) From Process**

<b>Non Hazardous Waste Type</b>	<b>Total During Previous Financial year</b>	<b>Total During Current Financial year</b>	<b>UOM</b>
Sludge from waste water treatment	5.9	5.66	MT/A

#### **2) From Pollution Control Facilities**

<b>Non Hazardous Waste Type</b>	<b>Total During Previous Financial year</b>	<b>Total During Current Financial year</b>	<b>UOM</b>
Boiler As	2889.47	2655.50	MT/A

#### **3) Quantity Recycled or Re-utilized within the unit**

<b>Waste Type</b>	<b>Total During Previous Financial year</b>	<b>Total During Current Financial year</b>	<b>UOM</b>
5.1 Used or spent oil	0.19	0.12	MT/A

## Part-F

**Please specify the characteristics(in terms of concentration and quantum) of hazardous as well as solid wastes and indicate disposal practice adopted for both these categories of wastes.**

#### **1) Hazardous Waste**

<b>Type of Hazardous Waste Generated</b>	<b>Qty of Hazardous Waste</b>	<b>UOM</b>	<b>Concentration of Hazardous Waste</b>
5.1 Used or spent oil	0.12	MT/A	0.12

#### **2) Solid Waste**

<b>Type of Solid Waste Generated</b>	<b>Qty of Solid Waste</b>	<b>UOM</b>	<b>Concentration of Solid Waste</b>
Boiler Ash	2655.50	MT/A	2655.50

## Part-G

**Impact of the pollution Control measures taken on conservation of natural resources and consequently on the cost of production.**

<b>Description</b>	<b>Reduction in Water Consumption (M3/day)</b>	<b>Reduction in Fuel &amp; Solvent Consumption (KL/day)</b>	<b>Reduction in Raw Material (Kg)</b>	<b>Reduction in Power Consumption (KWH)</b>	<b>Capital Investment(in Lacs)</b>	<b>Reduction in Maintenance(in Lacs)</b>
--------------------	--	---	---------------------------------------	---	------------------------------------	--

The 100% treated water from E.T.P. is recycled for land irrigation.	53	143.60	459	398	1800000	159812
---	----	--------	-----	-----	---------	--------

## Part-H

---

### **Additional measures/investment proposal for environmental protection abatement of pollution, prevention of pollution.**

#### **[A] Investment made during the period of Environmental Statement**

<b><i>Detail of measures for Environmental Protection</i></b>	<b><i>Environmental Protection Measures</i></b>	<b><i>Capital Investment (Lacks)</i></b>
Good House Keeping kept in a mfg p	Tree Plantation (Quantity 1000 Nos)	12.5

---

#### **[B] Investment Proposed for next Year**

<b><i>Detail of measures for Environmental Protection</i></b>	<b><i>Environmental Protection Measures</i></b>	<b><i>Capital Investment (Lacks)</i></b>
Good House Keeping kept in a mfg plant as well as ETP massive tree plantation done on available land.	Tree plantation (Quantity 1500 Nos)	4.90

## Part-I

---

### **Any other particulars for improving the quality of the environment.**

#### **Particulars**

We have planted about 500 Nos plants around the Bagasse yard for develop green belt around the premises. We are proposed to plant various type of tree in this year also.

#### **Name & Designation**

Mr. Uday Patil - Chief Executive Officer

#### **UAN No:**

MPCB-ENVIRONMENT\_STATEMENT-0000064684

#### **Submitted On:**

12-04-2024

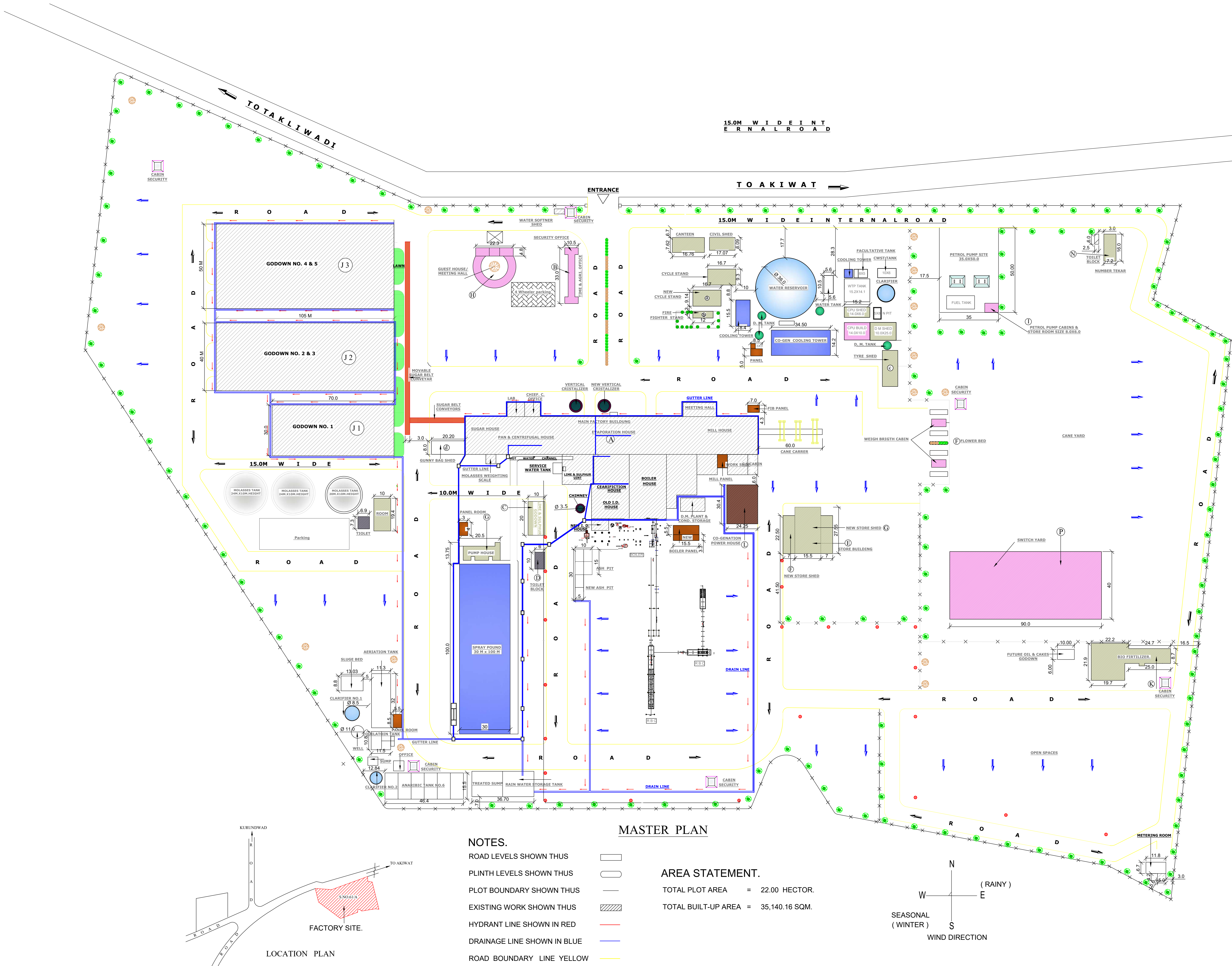

**NOTES**  
 THIS DRAWING IS THE PROPERTY OF ARCHITECTS & ENGINEERS PVT.LTD. & IS NOT TO BE USED OR REPRODUCED WITHOUT THEIR WRITTEN PERMISSION. THE CONTRACTOR MUST VERIFY ALL THE DIMENSIONS OF THE JOB & REPORT ANY DIMENSIONAL & OTHER DISCREPANCIES TO THE ARCHITECT.

REVISION	NO.	DATE

**DISTRIBUTION OF PRINTS**

CLIENT	CONT.	OFFICE	OTHERS	NO.	DATE

NORTH LINE & KEY PLAN

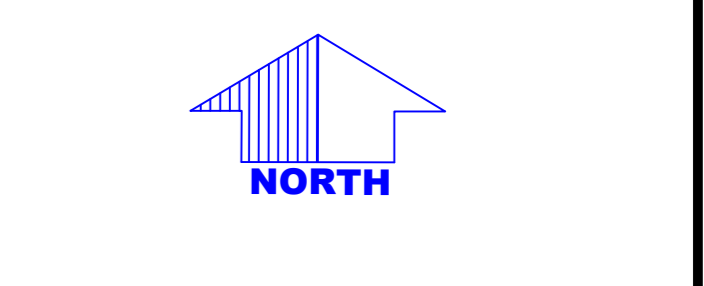

DRAWN BY: \_\_\_\_\_ CHECKED BY: \_\_\_\_\_

STRUCTURAL & ARCHITECTURAL CONSULTANTS

**PRASAD S.DABEER**

1031,E WARD,B-I-1  
 STERLING TOWERS,GAVAT MANDAI  
 SHAHUPURI,KOLHAPUR.  
 TEL-0231-3059450, CELL- 9890115549.

JOB  
**SHRI GURUDATTA SUGAR**

LTD.TAKLIWADI,

GAT NO.61

TAL.SHIROL.

DRAWING  
**MASTER PLAN**

SCALE: \_\_\_\_\_ DATE: 25/08/2017.

JOB NO. \_\_\_\_\_ DRG. NO.  
**A-0**

SUB JOB NUMBER \_\_\_\_\_ REVISION NUMBER **0**

- NOTES.**
- ROAD LEVELS SHOWN THUS
  - PLINTH LEVELS SHOWN THUS
  - PLOT BOUNDARY SHOWN THUS
  - EXISTING WORK SHOWN THUS
  - HYDRANT LINE SHOWN IN RED
  - DRAINAGE LINE SHOWN IN BLUE
  - ROAD BOUNDARY LINE YELLOW

**AREA STATEMENT.**

TOTAL PLOT AREA = 22.00 HECTOR.

TOTAL BUILT-UP AREA = 35,140.16 SQM.

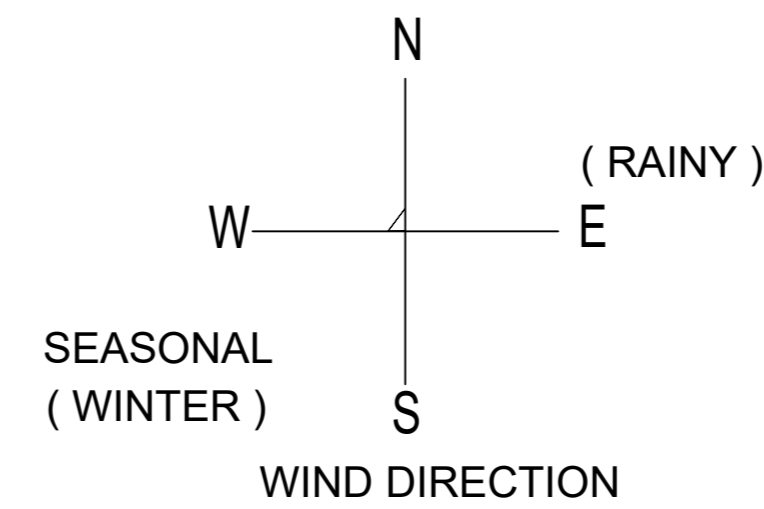

# MAHARASHTRA POLLUTION CONTROL BOARD

Tel: 24010706/24010437  
Fax: 24023516  
Website: <http://mpcb.gov.in>  
Email: [cac-cell@mpcb.gov.in](mailto:cac-cell@mpcb.gov.in)



Kalpataru Point, 2nd and 4th floor, Opp. Cine Planet Cinema, Near Sion Circle, Sion (E), Mumbai-400022

No:- Format1.0/CAC/UAN No.MPCB-  
CONSENT-0000170845/CR/2308000534

Date: 08/08/2023

To,  
Shri Gurudatt Sugars Ltd  
Gat No 61/A,Akiwat Takaliwadi Road, Takaliwadi,  
Shirol, Kolhapur.



**Sub: Renewal of Consent for 6000 TCD Sugar Unit and 21 MW Co generation unit**

- Ref:**
- 1. Renewal of consent granted by the Board vide no. Format1.0/CAC/UAN No.MPCB-CONSENT-0000139930/CR/2209001103 Date: 17.09.2022. Valid up to 31.07.2023.**
  - 2. Minutes of CAC meeting dtd. 07.07.2023**

Your application No.MPCB-CONSENT-0000170845 Dated 29.05.2023

For: grant of Consent to Renewal under Section 26 of the Water (Prevention & Control of Pollution) Act, 1974 & under Section 21 of the Air (Prevention & Control of Pollution) Act, 1981 and Authorization under Rule 6 and Rule 18(7) of the Hazardous & Other Wastes (Management & Transboundary Movement) Rules 2016 is considered and the consent is hereby granted subject to the following terms and conditions and as detailed in the schedule I, II, III & IV annexed to this order:

- 1. The Consent to Renewal is granted upto: 31.07.2024**
- 2. The capital investment of the industry is Rs.266.3266 Crs. (Existing - 256.91 Crs) Crs. (As per C.A Certificate submitted by industry).**
- 3. Consent is valid for the manufacture of:**

Sr No	Product	Maximum Quantity	UOM
1	Sugar	21600	MT/M
2	Molasses	7318	MT/M
3	Press Mud	7318	MT/M
4	Bagasse	54000	MT/M
5	Electric Power (Cogeneration)	21	MW

- 3. (The Cane crushing capacity of Sugar industry shall not exceed 6000 TCD.)**
- 4. Conditions under Water (P&CP) Act, 1974 for discharge of effluent:**

Sr No	Description	Permitted in CMD	Standards to	Disposal
1.	Trade effluent	518	As per Schedule -I	48 CMD shall be recycle & remaning 470 CMD shall be use on land for irrigation purpose.



<b>Sr No</b>	<b>Description</b>	<b>Permitted in CMD</b>	<b>Standards to</b>	<b>Disposal</b>
2.	Domestic effluent	48	As per Schedule - I	

5. **Conditions under the Air (P& CP) Act, 1981 for air emissions:**

<b>Stack No.</b>	<b>Description of stack / source</b>	<b>Number of Stack</b>	<b>Standards to be achieved</b>
1	Boiler ( 70 TPH) & (40 TPH)	1	As per Schedule -II
2	D.G. Set - (500 KVA) & (125 KVA)	1	As per Schedule -II
3	D.G. Set - ( 625 KVA X 2 NO.)	1	As per Schedule -II

(As per previous consent of existing unit)

6. **Conditions about Non Hazardous Wastes:**

<b>Sr No</b>	<b>Type of Waste</b>	<b>Quantity</b>	<b>UoM</b>	<b>Treatment</b>	<b>Disposal</b>
1	Boiler Ash	4536	MT/A	NA	Sale for Bricks Manufactures and for soil conditioning.
2	ETP Sludge	6.8	MT/A	NA	Use as Manure

7. **Conditions under Hazardous & Other Wastes (M & T M) Rules 2008 for treatment and disposal of hazardous waste:**

<b>Sr No</b>	<b>Type of Waste</b>	<b>HW Category.</b>	<b>Quantity &amp; UoM</b>	<b>Treatment</b>	<b>Disposal</b>
1	5.1 Used or spent oil	5.1	280 Kg/Annum	Recycle	Sale to authorized recycler.

The applicant shall ensure disposal to the Actual user having permissions under Rule 9 of Hazardous and other Waste (M & TM) Rules, 2016.

a. The applicant shall properly collect, transport & regularly dispose of the hazardous waste to CHWTSDf, in compliance of the Hazardous & Other Wastes (Management & Transboundary Movement) Rules, 2016 and keep proper manifest thereof.

8. The Board reserves the right to review, amend, suspend, revoke etc. this consent and the same shall be binding on the industry.
9. This consent should not be construed as exemption from obtaining necessary NOC/permission from any other Government authorities.
10. Industry shall connect online CMS data as per CPCB guidelines to CPCB & MPCB Servers.
11. Industry shall submit/extend Bank Guarantee of Rs. 25.0 Lakh towards Compliance of Consent conditions and O&M of Pollution Control System.
12. Industry shall provide scientific storage with proper APC system for ash.
13. This consent is issued as per the Consent Appraisal Committee meeting dated 07.07.2022.

14. The applicant shall make an application for renewal of the consent at least 60 days before the date of the expiry of the consent.

This consent is issued as per communication letter dated 03/11/2022 which is approved by competent authority of the board.



738886cc  
6ff9c003  
bb7e851f  
15a066a6  
cad3155b  
18feb00a  
a367c91e  
dc05e1f2

**Signed by: Dr J. B. Sangewar**  
Joint Director(WPC) & InCharge Of CAC-Cell  
For and on behalf of  
**Maharashtra Pollution Control Board**  
cac-cell@mpcb.gov.in  
2023-08-08 16:03:30 IST

**Received Consent fee of -**

Sr.No	Amount(Rs.)	Transaction/DR.No.	Date	Transaction Type
1	532653.00	TXN2305004251	29/05/2023	Online Payment
2	25000.00	TXN2306000650	05/06/2023	Online Payment

**Copy to:**

1. Regional Officer, MPCB, Kolhapur and Sub-Regional Officer, MPCB, Kolhapur  
- They are directed to ensure the compliance of the consent conditions.
2. Chief Accounts Officer, MPCB, Sion, Mumbai
3. CC/CAC desk - For record and website updation purpose.



## **SCHEDULE-I**

### **Terms & conditions for compliance of Water Pollution Control:**

- 1) **A] As per your application, you have Provided Effluent Treatment Plant (ETP) of designed capacity of 600.00 CMD consisting of Primary, Secondary, Tertiary for the treatment of 518.00 CMD industrial effluent.**
- B] Industry shall provide CPU for recycle/reuse of treated effluent.**
- C] The Applicant shall operate the effluent treatment plant (ETP) to treat the trade effluent so as to achieve the following standards prescribed by the Board or under EP Act, 1986 and Rules made there under from time to time, whichever is stringent.**

<b>Sr. No.</b>	<b>Parameters</b>	<b>Limiting concentration not to exceed in mg/l, except for pH</b>
(1)	pH	5.5-9.0
(2)	Oil & Grease	10
(3)	BOD (3 days 27 <sup>o</sup> )	100
(4)	Sulphate	1000
(5)	Suspended Solids	100
(6)	COD	250
(7)	Chloride	600
(8)	Total Dissolved Solids	2100

- D] The treated effluent 470.00 CMD shall be disposed on land for irrigation on 21.00 hectares of own land /as per the bilateral agreement with farmers. In no any case treated/untreated effluent shall find its way outside the factory premises directly or indirectly.**
- E] Industry shall operate Online Continuous Emission Monitoring System (OCEMS) and shall transmit Online Continuous Emission Monitoring System (OCEMS) data to Board's server directly through the data logger without any intermediate server.**
- F] Trade effluent of 48.00 CMD generated from Co-gen shall be 100% recycle in process.**
- G] CREP conditions for Sugar Factory**
- i. Operation of ETP shall be started at least one month before starting of cane crushing to achieve desired MLSS. So as to meet prescribed standards from day one the operation of mill.
  - ii. Waste water generation shall be reduced to 100 liters per tone of cane crushed.
  - iii. Industry shall achieve zero discharge into in land surface water bodies.
  - iv. 15 days' storage capacity tank shall be provided for treated effluent to take care during no demand for irrigation.
- H] Industry to make necessary arrangement to cover the effluent collection system and to avoid the ingress of Bagasse and other material.**

**I] The unit shall operate ETP even after completion of the crushing season so that any effluent generated during washing & maintenance activity is to be discharged after proper treatment.**

**J] The unit shall optimize water use in industrial process & maintain records.**

2) **A] As per your application, you have provided septic tank and soak pit for the treatment of 48.00 CMD sewage.**

**B] The applicant shall operate sewage treatment system to treat sewage so as to achieve the following standards/ prescribed under EP Act 1986 and rules made under time to time, whichever is stringent.**

1	Suspended Solids	Not to exceed	100 mg/l
2	BOD 3 days (27°C)	Not to exceed	100 mg/l

**C] The treated sewage shall be 100% reused/recycled for gardening purpose within premise. In no any case, sewage shall find its way outside Company's premises.**

3) The industry shall have bilateral agreement with the farmers on whose land the treated effluent is used for irrigation purposes and a copy of the agreements with validity shall be submitted to the Regional/Sub- Regional Office of the Board.

4) The industry shall create Environmental Cell by appointing an Environmental Engineer, Chemist and Agriculture expert for looking after day to day activities related to Environment and irrigation field where treated effluent is used for irrigation.

5) **CONDITIONS FOR MOLASSES STORAGE:**

(i) The molasses shall be properly collected and stored in steel tanks which shall be leak proof. At no stage of handling of molasses, there shall be leakage or spillage.

(ii) The capacity of tanks for storage of molasses shall be such that it will take care of bumper production of sugar, non-lifting of molasses etc.

(iii) All the area on which molasses are stored and handled should be provided with drain for diverting the spills to the treatment plant/ molasses tank. Suitable arrangements for accidental discharges of molasses from the tanks shall be provided to contain the same within factory premises.

(iv) Destruction of molasses and its disposal shall not be done without specific permission in writing from the authorized officer of the Board. Intimation of intention to destroy or dispose of the molasses shall be given to the Board at least 15 (fifteen) days in advance by registered post under intimation to the Sub-Regional officer and Regional officer of the Board under whose jurisdiction the factory is situated.

(v) The storage tanks shall be kept in good conditions all the year round with adequate maintenance. The tanks size and capacity per cm, height, total capacity in tonnes shall be displayed prominently near /on the tank.

(vi) The above conditions shall be in addition to and not in derogation of the provisions contained in the "Bombay Molasses Rules, 1955" and "Maharashtra Molasses Storage and Supply Regulation, 1965".

6) The Applicant shall provide Specific Water Pollution control system as per the conditions of EP Act, 1986 and rule made there under from time to time/ Environmental Clearance / CREP guidelines if applicable.

- 7) The Board reserves its rights to review plans, specifications or other data relating to plant setup for the treatment of waterworks for the purification thereof & the system for the disposal of sewage or trade effluent or in connection with the grant of any consent conditions. The Applicant shall obtain prior consent of the Board to take steps to establish the unit or establish any treatment and disposal system or an extension or addition thereto.
- 8) The industry shall ensure replacement of pollution control system or its parts after expiry of its expected life as defined by manufacturer so as to ensure the compliance of standards and safety of the operation thereof.
- 9) The Applicant shall comply with the provisions of the Water (Prevention & Control of Pollution) Act, 1974 and as amended, by installing water meters, and other provisions as contained in the said act:

<b>Sr. No.</b>	<b>Purpose for water consumed</b>	<b>Water consumption quantity (CMD)</b>
1.	Industrial Cooling, spraying in mine pits or boiler feed	475.00
2.	Domestic purpose	60.00
3.	Processing whereby water gets polluted & pollutants are easily biodegradable	1100.00
4.	Processing whereby water gets polluted & pollutants are not easily biodegradable and are toxic	0.00
5.	Grandening	0

- 10) The Applicant shall provide Specific Water Pollution control system as per the conditions of EP Act, 1986 and rule made there under from time to time/ Environmental Clearance/ CREP guidelines.

#### SCHEDULE-II

#### **Terms & conditions for compliance of Air Pollution Control:**

- 1) **As per your application, you have provided the Air pollution control (APC) system and erected following stack(s) and observe the following fuel pattern-**

<b>Stack No.</b>	<b>Stack Attached To</b>	<b>APC System</b>	<b>Height in Mtrs.</b>	<b>Type of Fuel</b>	<b>Quantity &amp; UoM</b>	<b>S%</b>	<b>SO<sub>2</sub></b>
1	Boiler (70 TPH)	Bagasse Dryer & WET Scrubber	65	Bagasse	730 MT/Day	0.20	2920.00
1	Boiler (40 TPH)	ESP	65	Bagasse	418 MT/Day	0.20	1672.00
2	D.G. Set - 500 KVA	Acoustic Enclosure	6	HSD	40 Ltr/Hr	1.00	19.20
2	D.G. Set - 125 KVA	Acoustic Enclosure	30	HSD	10 Ltr/Hr	1.00	4.80
3	D.G. Set - (625 KVA X 2 NO.)	Acoustic Enclosure	30	HSD	128 Ltr/Hr	1.00	61.44

(As per previous consent of existing unit)

**2) The Applicant shall provide Specific Air Pollution control equipments as per the conditions of EP Act, 1986 and rule made there under from time to time/ Environmental Clearance / CREP guidelines.**

1 The Applicant shall provide ESP/ Bag filter/ Wet scrubber to the Bagasse fired boiler and Dust Collector to Sugar bagging section as an Air Pollution control equipments OR as per the conditions of EP Act, 1986 and rule made there under from time to time / Environmental Clearance / CREP guidelines.

2 The applicant shall operate and maintain above mentioned air pollution control system, so as to achieve the level of pollutants to the following standards:

Total Particulate matter	Not to exceed	150 mg/Nm <sup>3</sup>
--------------------------	---------------	------------------------

3 The Applicant shall obtain necessary prior permission for providing additional control equipment with necessary specifications and operation thereof or alteration or replacement/alteration well before its life come to an end or erection of new pollution control equipment.

4 The Board reserves its rights to vary all or any of the condition in the consent, if due to any technological improvement or otherwise such variation (including the change of any control equipment, other in whole or in part is necessary).

5 Industry should not use auxiliary fuel more than 15 % (as per amendment in EIA Notification 2009, power plant upto 15 MW based on Bio-mass and using auxiliary fuel as coal upto 15% are exempt.) as co-gen capacity is below 15 MW.

**3) The Applicant shall obtain necessary prior permission for providing additional control equipment with necessary specifications and operation thereof or alteration or replacement/alteration well before its life come to an end or erection of new pollution control equipment.**

**4) The Board reserves its rights to vary all or any of the condition in the consent, if due to any technological improvement or otherwise such variation (including the change of any control equipment, other in whole or in part is necessary).**

**SCHEDULE-III**

**Details of Bank Guarantees:**

Sr. No.	Consent(C2E/C2O/C2R)	Amt of BG Imposed	Submission Period	Purpose of BG	Compliance Period	Validity Date
1	C to R	25 Lakh	15 days/ To be extended	Towards compliance of Consent conditions & O & M of pollution control system.	31.07.2024	28.02.2025

**BG Forfeiture History**

Srno.	Consent (C2E/C2O/C2R)	Amount of BG imposed	Submission Period	Purpose of BG	Amount of BG Forfeiture	Reason of BG Forfeiture
NA						

## SCHEDULE-IV

### **General Conditions:**

- 1 The applicant shall provide facility for collection of environmental samples and samples of trade and sewage effluents, air emissions and hazardous waste to the Board staff at the terminal or designated points and shall pay to the Board for the services rendered in this behalf.
- 2 The applicant shall provide ports in the chimney/(s) and facilities such as ladder, platform etc. for monitoring the air emissions and the same shall be open for inspection to/and for use of the Board's Staff. The chimney(s) vents attached to various sources of emission shall be designated by numbers such as S-1, S-2, etc. and these shall be painted/ displayed to facilitate identification.
- 3 Whenever due to any accident or other unforeseen act or even, such emissions occur or is apprehended to occur in excess of standards laid down, such information shall be forthwith Reported to Board, concerned Police Station, office of Directorate of Health Services, Department of Explosives, Inspectorate of Factories and Local Body. In case of failure of pollution control equipment, the production process connected to it shall be stopped.
- 4 The applicant shall provide an alternate electric power source sufficient to operate all pollution control facilities installed to maintain compliance with the terms and conditions of the consent. In the absence, the applicant shall stop, reduce or otherwise, control production to abide by terms and conditions of this consent.
- 5 The firm shall submit to this office, the 30th day of September every year, the Environmental Statement Report for the financial year ending 31st March in the prescribed Form-V as per the provisions of rule 14 of the Environment (Protection) (Second Amendment) Rules, 1992.
- 6 The industry should comply with the Hazardous & Other Wastes (M & TM) Rules, 2016 and submit the Annual Returns as per Rule 6(5) & 20(2) of Hazardous & Other Wastes (M & TM) Rules, 2016 for the preceding year April to March in Form-IV by 30th June of every year.
- 7 An inspection book shall be opened and made available to the Board's officers during their visit to the applicant.
- 8 The industry shall constitute an Environmental cell with qualified staff/personnel/agency to see the day to day compliance of consent condition towards Environment Protection.
- 9 The applicant shall install a separate meter showing the consumption of energy for operation of domestic and industrial effluent treatment plants and air pollution control system. A register showing consumption of chemicals used for treatment shall be maintained.
- 10 The applicant shall bring minimum 33% of the available open land under green coverage/ plantation. The applicant shall submit a yearly statement by 30th September every year on available open plot area, number of trees surviving as on 31st March of the year and number of trees planted by September end.
- 11 The industry shall submit official e-mail address and any change will be duly informed to the MPCB.
- 12 Industry should monitor effluent quality, stack emissions and ambient air quality monthly/quarterly.

- 13 The industry shall recycle/reprocess/reuse/recover Hazardous Waste as per the provision contain in the H&OW(M&TM) Rules 2016, which can be recycled/processed/ reused/ recovered and only waste which has to be incinerated shall go to incineration and waste which can be used for land filling and cannot be recycled/ reprocessed etc. should go for that purpose, in order to reduce load on incineration and landfill site/environment.
- 14 Industry shall strictly comply with the Water (P&CP) Act, 1974, Air (P&CP) Act,1981 and Environmental Protection Act,1986 and industry specific standard under EP Rules 1986 which are available on MPCB website(www.mpcb.gov.in).
- 15 Separate drainage system shall be provided for collection of trade and sewage effluents. Terminal manholes shall be provided at the end of the collection system with arrangement for measuring the flow. No effluent shall be admitted in the pipes/sewers downstream of the terminal manholes. No effluent shall find its way other than in designed and provided collection system.
- 16 Neither storm water nor discharge from other premises shall be allowed to mix with the effluents from the factory.
17. Conditions for D.G. Set
  - a) Noise from the D.G. Set should be controlled by providing an acoustic enclosure or by treating the room acoustically.
  - b) Industry should provide acoustic enclosure for control of noise. The acoustic enclosure/ acoustic treatment of the room should be designed for minimum 25 dB (A) insertion loss or for meeting the ambient noise standards, whichever is on higher side. A suitable exhaust muffler with insertion loss of 25 dB (A) shall also be provided. The measurement of insertion loss will be done at different points at 0.5 meters from acoustic enclosure/room and then average.
  - c) Industry should make efforts to bring down noise level due to DG set, outside industrial premises, within ambient noise requirements by proper siting and control measures.
  - d) Installation of DG Set must be strictly in compliance with recommendations of DG Set manufacturer.
  - e) A proper routine and preventive maintenance procedure for DG set should be set and followed in consultation with the DG manufacturer which would help to prevent noise levels of DG set from deteriorating with use.
  - f) D.G. Set shall be operated only in case of power failure.
  - g) The applicant should not cause any nuisance in the surrounding area due to operation of D.G. Set.
  - h) The applicant shall comply with the notification of MoEFCC, India on Environment (Protection) second Amendment Rules vide GSR 371(E) dated 17.05.2002 and its amendments regarding noise limit for generator sets run with diesel.
- 18 The industry should not cause any nuisance in surrounding area.
- 19 The industry shall take adequate measures for control of noise levels from its own sources within the premises so as to maintain ambient air quality standard in respect of noise to less than 75 dB (A) during day time and 70 dB (A) during night time. Day time is reckoned in between 6 a.m. and 10 p.m. and night time is reckoned between 10 p.m. and 6 a.m.
- 20 The applicant shall maintain good housekeeping.
- 21 The non-hazardous solid waste arising in the factory premises, sweepings, etc. be disposed of scientifically so as not to cause any nuisance / pollution. The applicant shall take necessary permissions from civic authorities for disposal of solid waste.
- 22 The applicant shall not change or alter the quantity, quality, the rate of discharge, temperature or the mode of the effluent/emissions or hazardous wastes or control equipment provided for without previous written permission of the Board. The industry will not carry out any activity, for which this consent has not been granted/without prior consent of the Board.



- 23 The industry shall ensure that fugitive emissions from the activity are controlled so as to maintain clean and safe environment in and around the factory premises.
- 24 The industry shall achieve the National Ambient Air Quality standards prescribed vide Government of India, Notification dtd. 16.11.2009 as amended.

---

This certificate is digitally & electronically signed.

---





# Maharashtra Pollution Control Board

महाराष्ट्र प्रदूषण नियंत्रण मंडळ

## Application for Consent/ Authorisation

Sir,  
I/We hereby apply for\*

- Consent to Establish/Operate/Renewal of consent under section 25 and 26 of the Water (Prevention & Control of Pollution) Act, 1974 as amended.
- Consent to Establish/Operate/Renewal of consent under Section 21 of the Air (Prevention and Control of Pollution) Act, 1981, as amended.
- Authorization/renewal of authorization under Hazardous and Other Wastes (Management and Transboundary Movement) Rules, 2016 in connection with my/our/existing/proposed/altered/ additional manufacturing/processing activity from the premises as per the details given below.

### Consent Information

**UAN No:**  
MPCB-CONSENT-0000208629

**Application submitted on:**  
08-05-2024

### Industry Information

**Consent To:**  
Renewal (Normal)

**IIN No.:**

**Submit to:**  
SRO - Kolhapur

**Type of institution:**  
Industry

**Industry Type:**  
R12 Sugar ( excluding  
Khandsari)

**Category:**  
Red

**Scale:**  
L.S.I

**Location of  
industry/activity/etc:**  
Local Body

**Name of Local Body:**  
Grampanchayat Takaliwadi

**EC Reqd.**  
Yes

**EC Obtained**  
EC Obtained

**EC Ref. No.**  
IA/MH/IND2/5991/2014

**Date of issue of EC**  
Jun 7, 2019

**Parivesh Proposal Number**  
J-11011/41/2015-IA-II(I)

**MoEFCC/SEIAA File Number**  
IA/MH/IND2/5991/2014

**Whether construction-buildup area is more than 20,000  
sq.mtr.(Existing Expansion Unit)**

No

### General Information

- Name, designation, office address with Telephone/Fax numbers, e-mail of the Applicant Occupier/Industry/Institution / Local Body.

**Name**  
Shri Rahul Madhavrao Ghatage

**Address**  
Gat No - 61/A, A/p - Takaliwadi

**Designation**  
Executive Director

**Taluka**  
Shirol

**Area**  
Akiwat -Takaliwadi Road

**District**  
Kolhapur

**Telephone**

7350799494

**Fax**

0231-2686000

**Email**

gslsugars.env@gmail.com

**Pan Number**

AAFCS8656L

2. (a) Name and location of the industrial unit/premises for which the application is made (Give revenue Survey Number/Plot number name of Taluka and District, also telephone and fax number)

**Industry name**

Shri Gurudatt Sugars Ltd

**Location of Unit**

Gat No 61/A, Akiwat Takaliwadi Road

**Survey number/Plot Number**

Gat No 61/A, Akiwat Takaliwadi Road

**Taluka**

Shirol

**District**

Kolhapur

(b) Details of the planning permission obtained from the local body/Town and Country Planning authority/Metropolitan Development authority/ designated Authority.

**Planning permission**

Registrar of Company

**Planning Authority**

Ministry of Commerce and Industry

Name of the local body under whose jurisdiction the unit is located and Name of the licence issuing authority

**Name of Local Body**

Takaliwadi Grampanchayat

**Name of the licence issuing authority**

Takaliwadi Grampanchayat

**Sanction plan/ Approved layout Plan/Commencement Certificate**

3. Names,addresses with Telephone and Fax Number of Managing Director / Managing Partner and officer responsible for matters connected with pollution control and/or Hazardous waste disposal.

**Name of Managing Director**

Shri Madhavrao Bhagavanrao Ghatage

**Telephone number**

02312686086

**Fax number**

02312686000

**Officer responsible for day to day business**

Mr Uday Patil

4. (a.) Are you registered Industrial unit ?

No

**Registration number**

77607000

**Date of registration**

Mar 1, 2000

5. Gross capital investment of the unit without depreciation till the date of application (Cost of building, land, plant and machinery). (To be supported by an affidavit/undertaking on Rs.20/- stamp paper, annual report or certificate from a Chartered Accountant for proposed unit(s), give estimated figure)

**Gross capital (in Lakh)**

26569.00

**\* Verified**

CA Certificate

**\* Terms**

1

**\* Consent Fee**

531380.00

6. If the site is located near sea-shore/river bank/other water bodies/Highway, Indicate the crow fly distance and the name of the water body, if any.

**Distance From**

SH/NH

**Distance(Km)**

8.00

**\* Name**

Ichalkarnji -Kurundwad Road

River

7.00

Krishna

Human Habitation

0.00

--NA--

Religious Place

0.00

--NA--

Historical Place

0.00

--NA--

Creek/Sea

0.00

--NA--

6b. Enter Latitude and Longitude details of site

<b>Latitude</b>	<b>Longitude</b>
0	0

7. Does the location satisfy the Requirements Under relevant Central/State Govt. Notification such as Coastal Regulation Zone. Notification on Ecologically Fragile Area, Industrial Location policy, etc. If so, give details.

<b>Location</b>	<b>Approved Industry Area</b>	<b>Sensitive Area</b>	<b>If Yes, Name Of Area</b>	<b>Industry Location with Reference to CRZ</b>
NA	No	No	NA	

8. If the site is situated in notified industrial estate,

		<b>Details</b>
<b>(a) Whether effluent collection, treatment and disposal system has been provided by the authority.</b>	Yes	Yes, Primary + Secondary + Tertiary
<b>(b) Will the applicant utilize the system, if provided.</b>	Yes	Yes, Primary + Secondary + Tertiary
<b>(c) If not provided, details of proposed arrangement.</b>	NA	

9.

<b>(a) Total plot area (in square meter)</b>	<b>(b) Built up area and (in square meter)</b>	<b>(c) Area available for the use of treated sewage/ trade effluent for gardening/irrigation. (in square meter)</b>
204461	17546	37348

10. Month and year of commissioning of the Unit.

2000-03-01

11. Number of workers and office staff

<b>Workers</b>	<b>staff</b>	<b>Hrs. of shift</b>	<b>Weekly off</b>
477	150	8	Sunday

12.

<b>(a) Do you have a residential colony Within the premises in respect of Which the present application is Made ?</b>	No	na		
<b>(b) If yes, please state population staying</b>				
<b>Number of person staying</b>	<b>Water consumption</b>	<b>Sewage generation</b>	<b>Whether is STP provided?</b>	
0	0	0	No	
<b>(c) Indicate its location and distance with reference to plant site.</b>				
<b>Number of person staying</b>	<b>Water consumption</b>			
NA	0			

13. List of products and by-products Manufactured in tonnes/month, Kl/month or numbers/month with their types i.e.Dyes, drugs etc. (Give figures corresponding to maximum installed production capacity)

**Products Name and Quantity**

<b>Product Name</b>	<b>UOM</b>	<b>Product Name</b>	<b>Existing</b>	<b>Consented</b>	<b>Proposed Revision</b>	<b>Total</b>	<b>Remarks</b>
---------------------	------------	---------------------	-----------------	------------------	--------------------------	--------------	----------------

Sugar (excluding Khandsari)	MT/M	Sugar	21600	21600	0	21600	NA
Sugar (excluding Khandsari)	MT/M	Press Mud	7318	7318	0	7318	NA
Sugar (excluding Khandsari)	MT/M	Molasses	7318	7318	0	7318	NA
Sugar (excluding Khandsari)	MT/M	Bagasse	54000	54000	0	54000	NA
Sugar (excluding Khandsari)	MW	Electric Power (Cogeneration)	21	21	0	21	NA

### Products Name and Quantity

Product Name	UOM	Quantity	Remarks
NA	--NA--	0	NA

14. List of raw materials and process chemicals with annual consumption corresponding to above stated production figures, in tonnes/month or kl/month or numbers/month.

Name of Raw Material	UOM	Quantity	Hazardous Waste	Hazardous Chemicals	Remarks
Sugar Cane	MT/M	180000	No	No	NA
Lime	MT/M	386	No	No	NA
Sulphure	MT/M	121	No	No	NA

15. Description of process of manufacture for each of the products showing input, output, quality and quantity of solid, liquid and gaseous wastes, if any from each unit process.

Copy of Manufacturing Process is Attached

### Part B : Waste Water aspects

16. Water consumption for different uses (m3/day)

Purpose	Consumption	Effluent Generation	Treatment	Remarks	Disposal	Remarks
Domestic Pourpose	60	48	Septic Tank	On land for Gardening	On Land for Gardening	On land for Gardening
Water gets Polluted & Pollutants are Biodegradable	1100	470	Primary + Secondary + Tertiary	On land for Gardening	On Land for Gardening	On land for Gardening
Water gets Polluted,Pollutants are not Biodegradable & Toxic	0	0	--NA--	0	--NA--	0
Industrial Cooling,spraying in mine pits or boiler feed	475	0	Primary + Secondary + Tertiary	On land for Gardening	On Land for Gardening	On land for Gardening
Others	0					

17. Source of water supply, Name of authority granting permission if applicable and quantity permitted.

**Source of water supply**

Irrigation Department

**Name of authority granting permission**

Irrigation Department Nursinhwadi Division

**Quantity permitted**

760

## 18. Quantity of waste water (effluent) generated (m3/day)

<b>Domestic</b>	<b>Boiler Blowdown</b>	<b>Industrial</b>	<b>Cooling water blowdown</b>
60	20	0	28
<b>Process</b>	<b>DM Plants/Softening</b>	<b>Washing</b>	<b>Tail race discharge from</b>
470	0	0	0

## 19. Water budget calculations accounting for difference between water consumption and effluent generated.

20

## 20. Present treatment of sewage/canteen effluent (Give sizes/capacities of treatment units).

**Capacity of STP (m3/day)**

0

<b>Treatment unit</b>	<b>Size (mxm)</b>	<b>Retention time (hr)</b>
NA	0	0

## 21. Present treatment of trade effluent (Give sizes/capacities of treatment units) (A schematic diagram of the treatment scheme with inlet/outlet characteristics of each unit operation/process is to be provided. Include details of residue Management system (ETP sludges)

**Capacity of ETP (m3/day)**

960

<b>Treatment unit</b>	<b>Size (mxm)</b>	<b>Retention time (hr)</b>
Bar Screen	1.5	0.06
Horizontal Oil & Grease Skimmer	40	1.62
Equilisation Tank	300	7.5
Anaerobic Digester	900	22.5
USAB	1012.5	25.31
Primary Aeration Tank	768	19.2
Primary Clarifier	122	3.05
Secondary Aeration Tank	1332	33.3
Secondary Clarifier	122	3.05
Dual Media Filter	0.8	0.03
Decanter Centrifuge / Sludge Drying Bed	1	1

## 22.

**(i) Are sewage and trade effluents mixed together?**

No

**If yes, state at which stage-Whether before, intermittently or after treatment.**

NA

## 23. Capacity of treated effluent sump, Guard Pond if any.

**Capacity of treated effluent sump (m3)** 8000**Effluent sump/Guard pond details** No NA**If yes, state at which stage-Whether before, intermittently or after treatment.** No NA

24. Mode of disposal of treated effluent With respective quantity, m3/day

<b>(i) into stream/river (name of river)</b>	NA	<b>(ii) into creek/estuary (name of Creek/estuary)</b>	NA
<b>(iii) into sea</b>	NA	<b>(iv) into drain/sewer (owner of sewer)</b>	NA
<b>(v) On land for irrigation on owned land/ase land. Specify cropped area.</b>	470 m3/Day - 50 Acre Own Land available for irrigation purpose.	<b>(vi) Connected to CETP</b>	NA
<b>(vii) Quantity of treated effluent reused/ recycled, m3/day Provide a location map of disposal arrangement indicating the outler(s) for sampling. Treated effluent reused / recycled (m3/day) Mode of disposal types other (if any)</b>	48	<b>Mode of disposal types</b>	Recycle

25. (a) Quality of untreated/treated effluents (Specify pH and concentration of SS, BOD,COD and specific pollutants relevant to the industry. TDS to be reported for disposal on land or into stream/river.

**Untreated Effluent**

<b>pH</b>	5.0
<b>SS (mg/l)</b>	132
<b>BOD (mg/l)</b>	910
<b>COD (mg/l)</b>	2452
<b>TDS (mg/l)</b>	1392
<b>Specific pollutant if any</b>	<b>Name</b> <b>Value</b>
1	NA 0

**Treated Effluent**

<b>pH</b>	7.3
<b>SS (mg/l)</b>	3
<b>BOD (mg/l)</b>	51
<b>COD (mg/l)</b>	132
<b>TDS (mg/l)</b>	1122
<b>Specific pollutant if any</b>	<b>Name</b> <b>Value</b>
1	NA NA

(b) Enclose a copy of the latest report of analysis from the laboratory approved by State Board/ Committee/Central Board/Central Government in the Ministry of Environment expected characteristics of the untreated/treated effluent

Copy of self monitoring report is attached.

26. Fuel consumption

<b>Fuel Type</b>	<b>UOM</b>	<b>Fuel Consumption TPD/LKD</b>	<b>Calorific value</b>
Bagasse	MT/Hr	36.9	2700
<b>Ash content</b>	<b>Sulphur content</b>	<b>Quantity</b>	<b>Other (specify)</b>
1.5	0.002	1	1

27. (a) Details of stack (process & fuel stacks: D. G. )

<b>(a) Stack number(s)</b>	<b>(b) Stack attached to</b>	<b>(c) Capacity</b>	<b>(d) Fuel Type</b>
1	Boiler 1 & 2 (Capacity - 70 MT/Hrs & 40 MT/Hrs).	110 TPH (70 TPH + 40 TPH)	Bagasse
<b>(e) Fuel quantity (Kg/hr.)</b>	<b>(f) Material of construction</b>	<b>(g) Shape (round/rectangular)</b>	<b>(h) Height, m (above ground level)</b>
36900	RCC	Round	65
<b>(i) Diameter/Size, in meters</b>	<b>(j) Gas quantity, Nm<sup>3</sup>/hr.</b>	<b>(k) Gas temperature °C</b>	<b>(l) Exit gas velocity, m/sec.</b>
3.43	102134.46	140	4.26
<b>(m) Control equipment preceding the stack</b>	<b>(n) Nature of pollutants likely to present in stack gases such as Cl<sub>2</sub>, Nox, Sox TPM etc.</b>	<b>(o) Emissions control system provided</b>	<b>(p) In case of D.G. Set power generation capacity in KVA</b>
ESP, Bagasse Dryer & WET Scrubber	TPM / SPM	ESP, Bagasse Dryer & WET Scrubber	NA

<b>(a) Stack number(s)</b>	<b>(b) Stack attached to</b>	<b>(c) Capacity</b>	<b>(d) Fuel Type</b>
2	D.G. Set 1	300 KVa	HSD
<b>(e) Fuel quantity (Kg/hr.)</b>	<b>(f) Material of construction</b>	<b>(g) Shape (round/rectangular)</b>	<b>(h) Height, m (above ground level)</b>
40	MS	ROUND	6
<b>(i) Diameter/Size, in meters</b>	<b>(j) Gas quantity, Nm<sup>3</sup>/hr.</b>	<b>(k) Gas temperature °C</b>	<b>(l) Exit gas velocity, m/sec.</b>
0.1	480	370	14.4
<b>(m) Control equipment preceding the stack</b>	<b>(n) Nature of pollutants likely to present in stack gases such as Cl<sub>2</sub>, Nox, Sox TPM etc.</b>	<b>(o) Emissions control system provided</b>	<b>(p) In case of D.G. Set power generation capacity in KVA</b>
Acoustic Enclosure	PM	Acoustic Enclosure	NA

<b>(a) Stack number(s)</b>	<b>(b) Stack attached to</b>	<b>(c) Capacity</b>	<b>(d) Fuel Type</b>
3	D.G. Set 2	125 KVa	HSD
<b>(e) Fuel quantity (Kg/hr.)</b>	<b>(f) Material of construction</b>	<b>(g) Shape (round/rectangular)</b>	<b>(h) Height, m (above ground level)</b>
10	MS	ROUND	6
<b>(i) Diameter/Size, in meters</b>	<b>(j) Gas quantity, Nm<sup>3</sup>/hr.</b>	<b>(k) Gas temperature °C</b>	<b>(l) Exit gas velocity, m/sec.</b>
0.1	410	126	12.7
<b>(m) Control equipment preceding the stack</b>	<b>(n) Nature of pollutants likely to present in stack gases such as Cl<sub>2</sub>, Nox, Sox TPM etc.</b>	<b>(o) Emissions control system provided</b>	<b>(p) In case of D.G. Set power generation capacity in KVA</b>
Acoustic Enclosure	PM	Acoustic Enclosure	NA

<b>(a) Stack number(s)</b>	<b>(b) Stack attached to</b>	<b>(c) Capacity</b>	<b>(d) Fuel Type</b>
3	D.G. Set 3	625 KVa x 02 Nos	HSD
<b>(e) Fuel quantity (Kg/hr.)</b>	<b>(f) Material of construction</b>	<b>(g) Shape (round/rectangular)</b>	<b>(h) Height, m (above ground level)</b>
128	MS	ROUND	30
<b>(i) Diameter/Size, in meters</b>	<b>(j) Gas quantity, Nm<sup>3</sup>/hr.</b>	<b>(k) Gas temperature °C</b>	<b>(l) Exit gas velocity, m/sec.</b>
0.254	410	126	12.7
<b>(m) Control equipment preceding the stack</b>	<b>(n) Nature of pollutants likely to present in stack gases such as Cl<sub>2</sub>, Nox, Sox TPM etc.</b>	<b>(o) Emissions control system provided</b>	<b>(p) In case of D.G. Set power generation capacity in KVA</b>
Acoustic Enclosure	PM	Acoustic Enclosure	NA



27. (B) Whether any release of odoriferous compounds such as Mercaptans, Phorate etc. Are coming out from any storages or process house.

NA

28. Do you have adequate facility for collection of samples of emissions in the form of port holes, platform, ladder/etc. As per Central Board Publication "Emission regulations Part-III" ( December, 1985 )

<b>Poart hole</b>	Yes	<b>Details</b>	Yes, Provided.
<b>Platform</b>	Yes	<b>Details</b>	Yes, Provided.
<b>Ladder</b>	Yes	<b>Details</b>	Yes, Provided.

29. Quality of treated flue gas emissions and process emissions. Quantity of treated flue gas emissions and process emissions.

<b>Sr. No</b>	<b>Stack attached to</b>	<b>Parameter</b>	<b>Concentration mg/Nm3</b>	<b>flow (Nm3/hr)</b>
1	Boiler 1 & 2 (Capacity - 70 MT/Hrs & 40 MT/Hrs).	PM	68.74	108732.32

(Specify concentration of criteria pollutants and industry/process-specific pollutants stack-wise. Enclose a copy of the latest report of analysis from the laboratory approved by State Board/Central Board/Central Government in the Ministry of Environment & Forests. For proposed unit furnish expected characteristics of the emissions..

Copy of Self Monitoring reports for flue gas emission are attached.

#### Part - D: Hazardous Waste aspect

30 Information about Hazardous Waste Management as defined in Hazardous Waste (Management & Handling ) Rules, 1989 as amended in Jan.,2000. Type/Category of Waste as per

##### Waste (Annually) Schedule I

<b>Cat No</b>	<b>Type</b>	<b>Qty</b>	<b>UOM</b>
5.1	5.1 Used or spent oil	280	Kg/Annum
<b>Max</b>	<b>Method of collection</b>	<b>Method of reception</b>	<b>Method of storage</b>
	NA	NA	NA
<b>Method of transport</b>	<b>Method of treatment</b>	<b>Method of disposal</b>	
NA	NA	Reused as fuel in own boiler along with Bagasse.	

##### Waste (Annually) Schedule II

31. Details about use of hazardous waste

<b>Name of hazardous waste/Spent chemical</b>	<b>Quantity used/month</b>	<b>Party from whom purchased</b>	<b>Party to whom sold</b>
NA	0	NA	NA

32.

a. Details about technical capability and equipments available with the applicant to handle the Hazardous Waste

NA

b. Characteristics of hazardous waste(s) Specify concentration of relevant pollutants. Enclose a copy of the latest report of analysis from the laboratory approved by State Board/Central Board/Central Govt. in the ministry of Environment & Forests. For proposed units furnish expected characteristics

NA

33.

**Copy of format of manifest/record Keeping practiced by the applicant.**

NA

---

34.

**Details of self-monitoring (source and environment system)**

NA

---

35.

**Are you using any imported hazardous waste. If yes, give details.**

NA

---

36.

**Copy of actual user Registration/certificate obtained from State Pollution Control Board/Ministry of Environment & Forests, Government of India, for use of hazardous waste.**

NA

---

37.

**Present treatment of hazardous waste, if any (give type and capacity of treatment units)**

NA

---

38. Quantity of hazardous waste disposal

**(i) Within factory**

0

**(ii) Outside the factory (specify location and enclose copies of agreement.)**

0

**(iii) Through sale (enclosed documentary proof and copies of agreement.)**

0

**(iv) Outside state/Union Territory, if yes particulars of (1 & 3 ) above.**

0

**(v) Other (Specify)**

0

---

#### **Part - E: Additional information**

---

39.

**a. Do you have any proposals to upgrade the present system for treatment and disposal of effluent/emissions and/or hazardous waste.**

NA

**b. If yes, give the details with time- schedule for the implementation and approximate expenditure to be incurred on it.**

NA

---

40.

**Capital and recurring (O & M) expenditure on various aspect of environment protection such as effluent, emission, hazardous waste, solid waste, tree- plantation, monitoring, data acquisition etc. (give figures separately for items implemented/to be implemented).**

ETP Capital Cost - 675 Lacs, Recurring Cost of ETP - Rs. 4.6 Lacs / Month & Capital Cost of APC - Rs 11.96 Cr.

---

41.

**To which of the pollution control equipment, separate meters for recording consumption of electric energy are installed ?**

NA

---

42.

**Which of the pollution control items are connected to D.G. Set (captive power source) to ensure their running in the event of normal power failure**

NA

---

43. Nature, quantity and method of disposal of non- hazardous solid waste generated separately from the process of manufacture and waste treatment. (Give details of area/capacity available in applicant's land)

Type	Quantity	UOM	Treatment	Disposal	Other Details
Boiler Ash	4561	Kg/Annum	NA	Sale for Bricks Manufactures and for soil conditioning	NA
Sludge from waste water treatment	6.9	MT/A	NA	Use as Manure	NA

---

44. Hazardous Chemicals - Give details of Chemicals and quantities handled and Stored.

**(i) Is the unit a Major Accident Hazard unit as per Mfg.Storage Import Hazardous Chemicals Rules ?**

NA

**(ii) Is the unit an isolated storage as defined under the MSIHC Rules ?**

NA

**(iii) Indicate status of compliance of Rules 5,7,10,11,12,13 and 18 of the MSIHC Rules.**

NA

**(iv) Has approval of site been obtained from the concerned authority?**

NA

**(v) Has the unit prepared an off-site Emergency Plan? Is it updated ?**

NA

**(vi) Has information on imports of Chemicals been provided to the concerned authority?**

NA

**(vii) Does the unit possess a policy under the PLI Act?**

NA

---

45. Brief details of tree plantation/green belt development within applicant's premises ( in hectares )

Open Space Availability	Plantation Done On	Number of Trees Planted
37348 Square meter	13151 Square meter(35 %)	9890

---

46.

**Information of schemes for waste Minimization, resource recovery and recycling - implemented and to be implemented, separately.**

Bagasse Dryer is installed to reduce fuel consumption in boiler. We have provided Condensate Polishing Unit for sugar factory excess condensate water reuse & recycle purpose.

---

47.

**(a) The applicant shall indicate whether Industry comes under Public Hearing, if so, the relevant documents such as EIA, EMP, Risk Analysis etc. shall be submitted, if so, the relevant documents enclosed shall be indicated accordingly.**

NA

**(b) Any other additional information that the applicants desires to give**

NA

(c) Whether Environmental Statement submitted ? If submitted, give date of submission.

Yes, submitted on dated 06.04.2024 for year 2023-2024

48.

I/We further declare that the information furnished above is correct to the best of my/our knowledge.

49.

I/We hereby submit that in case of any change from what is stated in this application in respect of raw materials, products, process of manufacture and treatment and/or disposal of effluent, emission, hazardous wastes etc. In quality and quantity; a fresh application for Consent/Authorization shall be made and until the grant of fresh Consent/Authorization no change shall be made.

50.

I/We undertake to furnish any other information within one month of its being called by the Board

Yours faithfully

Signature :

Name : Mr. Rahul Madhavrao Ghatge

Designation : Executive Director

#### Additional Information

#### Air Pollution

Sr No.	Air Pollution Source	Pollutants	APCS Provided	Remark
1	Boiler - 1 & 2 (70 TPH and 40 TPH)Boiler - 1 & 2 (70 TPH and 40 TPH)	TPM	Boiler - 1 & 2 (WET SCRUBBER & DRYER - 70 TPH and 40 TPH)	NA

**Separate EM Provided** Yes **Other Emission Sources** N.A.

**Measures Proposed** YES **Foul Smell Coming Out** No

**Air Sampling Facility Details** Port Hole, Platform, Ladder, Electrical Supply for flue gas sampling has been provided.

#### D.G. Set Details

Description	Capacity(KVA)	Remarks
D.G Set - 1	500	NA
D.G Set - 2	125	NA
D.G Set - 3	625	NA
D.G Set - 4	625	NA

#### Hazardous Waste Generation

Hazardous Waste	Quantity	UOM	Treatment	Disposal	Other Details
5.1 Used or spent oil	280	Kg/Annum	NA	Reuse in own Boiler as a Fuel	NA

#### CHWTSDF Details

Member of CHWTSDF	CHWTSDF Name	Remarks
-------------------	--------------	---------

---

## Cess Details

---

**Cess Applicable**

Yes

**Cess Paid**

Yes

**If Yes, UpTo**Jul 30 2017 12:00:00:000AM

---

## Legal Actions

---

**Legal Action Taken**

No

**Legal Record Of Company****Legal Action Details****Remarks**

---

**Bank Guarantee Applicable:**

Yes

**BG Details**

Towards compliance of Consent conditions &amp; O &amp; M of pollution control system.

**BG Amount**

2500000

**BG Validity**

31-12-2024

**Applicable against Consent:**

Yes

- MPCB-BG-0000026337 (N41GOPG232355003)

**Applicable against Direction:**No

---

## Annexure

**FORM 7**

( See Rule 18 (7) and schedules II,III,IV,VI,VIII,X,XI,XIII,XIV,XV,XVII,XVIII & XX to Rule 114 )  
**SHRI GURUDATT SUGARS LIMITED**  
 ( Health Register )

**CERTIFYING SURGEON**  
**DR. ARVIND MANE**  
 MBBS DPH AFIH.(MUMBAI)

( In respect of persons employed in occupations declared to be dangerous operations under sections 87 )

DSD Security

From: { 12-01-24 To 11-01-25 }

Serial No.	Works No.	Name of Worker	Sex	Age (Last birth -day)	Dept. of employment of present work	Date of Leaving or Transfer to Other	Reason For Leaving Transfer of Discharge	Nature of Job or Occupation	Raw Material or by Product Handeled	Date of Medical Examination by Certifying Surgeon	Result of Medical Examination	work, state Period of Suspension with Detailed Reasons	Certified fit to resume duty on with signature of certifying surgeon	unfitness or suspection issued to	Signature with Date of Certifying Surgeon
1	2	3	4	5	6	7	8	9	10	11		12	13	14	15
1	100	Bharat B. Jadhav	Male	57	Security	NA	NA			13-01-24	FIT	NA	NA	NA	
2	14001	Sham S. Patil	Male	42	Security	NA	NA			13-01-24	FIT	NA	NA	NA	
3	14005	Sumit Bandu Khot	Male	23	Security	NA	NA			13-01-24	FIT	NA	NA	NA	
4	14006	Siddharath K. Kamble	Male	35	Security	NA	NA			13-01-24	FIT	NA	NA	NA	
5	14007	Yogesh S. Dharangutte	Male	27	Security	NA	NA			13-01-24	FIT	NA	NA	NA	
6	14008	Nitin G. Madhale	Male	36	Security	NA	NA			13-01-24	FIT	NA	NA	NA	
7	14010	Pramod Y. Kadam	Male	43	Security	NA	NA			13-01-24	FIT	NA	NA	NA	
8	14014	Shubham Narayan Gaikwad	Male	26	Security	NA	NA			13-01-24	FIT	NA	NA	NA	
9	14016	Prakash Ramu Repe	Male	39	Security	NA	NA			13-01-24	FIT	NA	NA	NA	
10	14017	Prakash A. Gaykwad	Male	28	Security	NA	NA			13-01-24	FIT	NA	NA	NA	
11	14018	Avadhut S. Jagtap	Male	52	Security	NA	NA			13-01-24	FIT	NA	NA	NA	
12	14019	Rushikesh Balasaheb Thorat	Male	25	Security	NA	NA			13-01-24	FIT	NA	NA	NA	
13	14021	Sagar R. Apraj	Male	30	Security	NA	NA			13-01-24	FIT	NA	NA	NA	
14	14022	Chidanand R. Dharangutte	Male	24	Security	NA	NA			13-01-24	FIT	NA	NA	NA	
15	14023	Shivram E. Kamble	Male	41	Security	NA	NA			13-01-24	FIT	NA	NA	NA	
16	14024	Shashidhar Kamble	Male	40	Security	NA	NA			13-01-24	FIT	NA	NA	NA	
17	14025	Vinod R. Kadam	Male	44	Security	NA	NA			13-01-24	FIT	NA	NA	NA	
18	14026	Sanjay S. Patil	Male	49	Security	NA	NA			13-01-24	FIT	NA	NA	NA	
19	14027	Shahir S. Chavare	Male	59	Security	NA	NA			13-01-24	FIT	NA	NA	NA	
20	14028	Swapnil B. Mohite	Male	27	Security	NA	NA			13-01-24	FIT	NA	NA	NA	
21	14029	Prabhakar A. Aadake	Male	36	Security	NA	NA			13-01-24	FIT	NA	NA	NA	
22	-	Sambhaji A. Pujari	Male	45	Security	NA	NA			13-01-24	FIT	NA	NA	NA	

  
 कारखाने अधिनियम १९४८ च्या कलम १०(२) प्रमाणे  
 कोल्हापूर जिल्हाकरिता  
 प्राधिकृत प्रमाणकशल्यचिकित्सक  
 क्र. ACS 15-AM/2016

## FORM 7

( See Rule 18 (7) and schedules II,III,IV,VI,VIII,X,XI,XIII,XIV,XV,XVII,XVIII & XX to Rule 114 )  
**SHRI GURUDATT SUGARS LIMITED**  
 ( Health Register )

**CERTIFYING SURGEON**  
**DR. ARVIND MANE**  
 MBBS DPH AFIH.(MUMBAI)

( In respect of persons employed in occupations declared to be dangerous operations under sections 87 )

Nirmal Jyot

From: { 12-01-24 To 11-01-25 }

Serial No.	Works No.	Name of Worker	Sex	Age (Last birth -day)	Dept. of employment of present work	Date of Leaving or Transfer to Other	Reason For Leaving Transfer of Discharge	Nature of Job or Occupation	Raw Material or by Product Handeled	Date of Medical Examination by Certifying Surgeon	Result of Medical Examination	work, state Period of Suspension with Detailed Reasons	Certified fit to resume duty on with signature of certifying surgeon	unfitness or suspenstion issued to	Signature with Date of Certifying Surgeon
1	2	3	4	5	6	7	8	9	10	11	12	13	14	15	
1	10015	Vinayak K. Ghatage	Male	37	Agriculture	NA	NA			13-01-24	FIT	NA	NA	NA	
2	16001	Vijay M. Patil	Male	30	ETP	NA	NA			13-01-24	FIT	NA	NA	NA	
3	16002	Amin D. Mulla	Male	30	Store	NA	NA			13-01-24	FIT	NA	NA	NA	
4	16003	Dipak S. Badame	Male	31	Manufacturing	NA	NA			13-01-24	FIT	NA	NA	NA	
5	16005	Pravin P. Kamble	Male	29	ETP	NA	NA			13-01-24	FIT	NA	NA	NA	
6	16007	Mahesh G. Kamble	Male	32	WTP	NA	NA			13-01-24	FIT	NA	NA	NA	
7	16009	Appaso D. Khot	Male	33	Store	NA	NA			13-01-24	FIT	NA	NA	NA	
8	16009	Babaso A. Kumbhar	Male	30	WTP	NA	NA			13-01-24	FIT	NA	NA	NA	
9	16012	Anil G. Patil	Male	37	Caneyard	NA	NA			13-01-24	FIT	NA	NA	NA	
10	16013	Ramesh B. Jadhav	Male	43	Caneyard	NA	NA			13-01-24	FIT	NA	NA	NA	
11	16017	Atul S. Chudumunge	Male	31	Agriculture	NA	NA			13-01-24	FIT	NA	NA	NA	
12	16019	Vinod B. Sokande	Male	31	Agriculture	NA	NA			13-01-24	FIT	NA	NA	NA	
13	16020	Pandurang R. Dhangar	Male	45	Caneyard	NA	NA			13-01-24	FIT	NA	NA	NA	
14	16021	Namdev K. Nirmale	Male	36	WTP	NA	NA			13-01-24	FIT	NA	NA	NA	
15	16022	Dadaso Babaso Bhamane	Male	30	Co-Generation	NA	NA			13-01-24	FIT	NA	NA	NA	
16	16023	Santosh N. Kamble	Male	31	Electrician	NA	NA			13-01-24	FIT	NA	NA	NA	
17	16025	Chandrakant P. Biranage	Male	34	Engineering	NA	NA			13-01-24	FIT	NA	NA	NA	
18	16026	Rohit M. Patil	Male	27	ETP	NA	NA			13-01-24	FIT	NA	NA	NA	
19	16027	Vaibhav B. Yedake	Male	29	WTP	NA	NA			13-01-24	FIT	NA	NA	NA	
20	16031	Ajit S. Patil	Male	34	Electrician	NA	NA			13-01-24	FIT	NA	NA	NA	
21	16032	Balaso Lahu Kamble	Male	27	WTP	NA	NA			13-01-24	FIT	NA	NA	NA	
22	16033	Shubham A. Patil	Male	24	WTP	NA	NA			13-01-24	FIT	NA	NA	NA	
23	16034	Prajyot M. Ingale	Male	34	Caneyard	NA	NA			13-01-24	FIT	NA	NA	NA	
24	16035	Shrimant B. Latkar	Male	33	Caneyard	NA	NA			13-01-24	FIT	NA	NA	NA	
25	16036	Santosh Vasant Kumbhar	Male	35	Engineering	NA	NA			13-01-24	FIT	NA	NA	NA	
26	16037	Rahul Tanaji Kumbhar	Male	30	Juss	NA	NA			13-01-24	FIT	NA	NA	NA	
27	16038	Yuvraj A. Mane	Male	37	Engineering	NA	NA			13-01-24	FIT	NA	NA	NA	

  
 कारखाने अधिनियम १९४८ च्या कलम १०(२) प्रमाणे  
 कोल्हापूर जिल्हाकरिता  
 प्राधिकृत प्रमाणकशल्यचिकित्सक  
 क्र. ACS 15-AM/2016

**FORM 7**

( See Rule 18 (7) and schedules II,III,IV,VI,VIII,X,XI,XIII,XIV,XV,XVII,XVIII & XX to Rule 114 )  
**SHRI GURUDATT SUGARS LIMITED**  
 ( Health Register )

**CERTIFYING SURGEON**  
**DR. ARVIND MANE**  
 MBBS DPH AFIH.(MUMBAI)

( In respect of persons employed in occupations declared to be dangerous operations under sections 87 )

Nirmal Jyot

From: { 12-01-24 To 11-01-25 }

Serial No.	Works No.	Name of Worker	Sex	Age (Last birth -day)	Dept. of employment of present work	Date of Leaving or Transfer to Other	Reason For Leaving Transfer of Discharge	Nature of Job or Occupation	Raw Material or by Product Handeled	Date of Medical Examination by Certifying Surgeon	Result of Medical Examination	work, state Period of Suspension with Detailed Reasons	Certified fit to resume duty on with signature of certifying surgeon	unfitness or suspection issued to	Signature with Date of Certifying Surgeon
1	2	3	4	5	6	7	8	9	10	11		12	13	14	15
28	16039	Sachin V. Kumbhar	Male	38	Engineering	NA	NA			13-01-24	FIT	NA	NA	NA	
29	16041	Appaso P. Narute	Male	38	Engineering	NA	NA			13-01-24	FIT	NA	NA	NA	
30	16043	Sagar A. Mali	Male	35	Caneyard	NA	NA			13-01-24	FIT	NA	NA	NA	
31	16044	Satish N. Gaykwad	Male	29	Caneyard	NA	NA			13-01-24	FIT	NA	NA	NA	
32	16045	Nikhil P. Patil	Male	29	Caneyard	NA	NA			13-01-24	FIT	NA	NA	NA	
33	16046	Chandrakant V. Magdum	Male	42	Caneyard	NA	NA			13-01-24	FIT	NA	NA	NA	
34	16048	Sushant P. Kosti	Male	27	WTP	NA	NA			13-01-24	FIT	NA	NA	NA	
35	16054	Machindranath A. Davari	Male	53	WTP	NA	NA			13-01-24	FIT	NA	NA	NA	
36	16055	Amar Ashok Korale	Male	36	Caneyard	NA	NA			13-01-24	FIT	NA	NA	NA	
37	-	Vishal Ravasaheb Bage	Male	27	HR	NA	NA			13-01-24	FIT	NA	NA	NA	

  
 कारखाने अधिनियम १९४८ च्या कलम १०(२) प्रमाणे  
 कोल्हापूर जिल्हाकरिता  
 प्राधिकृत प्रमाणकशल्यचिकित्सक  
 क्र. ACS 15-AM/2016



**FORM 7**

( See Rule 18 (7) and schedules II,III,IV,VI,VIII,X,XI,XIII,XIV,XV,XVII,XVIII & XX to Rule 114)

**SHRI GURUDATT SUGARS LIMITED**

**( Health Register )**

**( In respect of persons employed in occupations declared to be dangerous operations under sections 87 )**

**CERTIFYING SURGEON**

**DR. ARVIND MANE**

**MBBS DPH AFIH.(MUMBAI)**

Pramutech Services Ltd.

From: { 12-01-24 To 11-01-25 }

Serial No.	Works No.	Name of Worker	Sex	Age (Last birth -day)	Dept. of employment of present work	Date of Leaving or Transfer to Other	Reason For Leaving Transfer of Discharge	Nature of Job or Occupation	Raw Material or by Product Handeled	Date of Medical Examination by Certifying Surgeon	Result of Medical Examination	work, state Period of Suspension with Detailed Reasons	Certified fit to resume duty on with signature of certifying surgeon	unfitness or suspenstion issued to	Signature with Date of Certifying Surgeon
1	2	3	4	5	6	7	8	9	10	11	12	13	14	15	
1	1106	Rakesh R. Savadatti	Male	26	Co-Generation	NA	NA			13-01-24	FIT	NA	NA	NA	
2	11006	Kapil S. Gidd	Male	32	Distillery	NA	NA			13-01-24	FIT	NA	NA	NA	
3	11007	Tejas P. Patil	Male	27	Distillery	NA	NA			13-01-24	FIT	NA	NA	NA	
4	11009	Ramesh R. Kadam	Male	41	Distillery	NA	NA			13-01-24	FIT	NA	NA	NA	
5	11012	Satish N. Patil	Male	40	Distillery	NA	NA			13-01-24	FIT	NA	NA	NA	
6	11014	Gangadhar R. Bhosale	Male	30	Distillery	NA	NA			13-01-24	FIT	NA	NA	NA	
7	11019	Pravin B. Mali	Male	31	Distillery	NA	NA			13-01-24	FIT	NA	NA	NA	
8	11020	Manjunath S. Patil	Male	31	Distillery	NA	NA			13-01-24	FIT	NA	NA	NA	
9	11021	Adinath M. Nirmale	Male	26	D.E.	NA	NA			13-01-24	FIT	NA	NA	NA	
10	11022	Farukh M. Khan Mokashi	Male	37	Electrician	NA	NA			13-01-24	FIT	NA	NA	NA	
11	11023	Pravin P. Patil	Male	0	Distillery	NA	NA			13-01-24	FIT	NA	NA	NA	
12	11024	Kadagouda B. Patil	Male	44	Distillery	NA	NA			13-01-24	FIT	NA	NA	NA	
13	11027	Ajitsinh B. Padaval	Male	31	Distillery	NA	NA			13-01-24	FIT	NA	NA	NA	
14	11033	Ganesh V. Khot	Male	23	Distillery	NA	NA			13-01-24	FIT	NA	NA	NA	
15	11042	Sakul S. Latakar	Male	27	Distillery	NA	NA			13-01-24	FIT	NA	NA	NA	
16	11044	Vipul A. Patil	Male	29	Distillery	NA	NA			13-01-24	FIT	NA	NA	NA	
17	11049	Ravikiran E. Dhavale	Male	44	Co-Generation	NA	NA			13-01-24	FIT	NA	NA	NA	
18	11051	Sourabh S. Gaukude	Male	25	Distillery	NA	NA			13-01-24	FIT	NA	NA	NA	
19	11054	Amol V. Jagtap	Male	40	Distillery	NA	NA			13-01-24	FIT	NA	NA	NA	
20	11055	Shivanand S. Langre	Male	26	Distillery	NA	NA			13-01-24	FIT	NA	NA	NA	
21	11056	Amol S. Patil	Male	27	Distillery	NA	NA			13-01-24	FIT	NA	NA	NA	
22	11057	Sourabh M. Kakade	Male	27	Distillery	NA	NA			13-01-24	FIT	NA	NA	NA	
23	11059	Umesh M. Kagale	Male	36	Engineering	NA	NA			13-01-24	FIT	NA	NA	NA	
24	11061	Ranjit S. Patil	Male	27	Distillery	NA	NA			13-01-24	FIT	NA	NA	NA	
25	11063	Kashinath D. Goundi	Male	31	Distillery	NA	NA			13-01-24	FIT	NA	NA	NA	
26	11065	Sunil S. Sajane	Male	34	Engineering	NA	NA			13-01-24	FIT	NA	NA	NA	
27	11065	Prasad A. Kumbhar	Male	37	Engineering	NA	NA			13-01-24	FIT	NA	NA	NA	

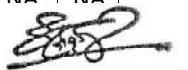
  
 कारखाने अधिनियम १९४८ च्या कलम १०(२) प्रमाणे  
 कोल्हापूर जिल्हाकरिता  
 प्राधिकृत प्रमाणकशल्यचिकित्सक  
 क्र. ACS 15-AM/2016

**FORM 7**

( See Rule 18 (7) and schedules II,III,IV,VI,VIII,X,XI,XIII,XIV,XV,XVII,XVIII & XX to Rule 114)

**SHRI GURUDATT SUGARS LIMITED**

**( Health Register )**

**( In respect of persons employed in occupations declared to be dangerous operations under sections 87 )**

**CERTIFYING SURGEON**

**DR. ARVIND MANE**

**MBBS DPH AFIH.(MUMBAI)**

Pramutech Services Ltd.

From: { 12-01-24 To 11-01-25 }

Serial No.	Works No.	Name of Worker	Sex	Age (Last birth -day)	Dept. of employment of present work	Date of Leaving or Transfer to Other	Reason For Leaving Transfer of Discharge	Nature of Job or Occupation	Raw Material or by Product Handeled	Date of Medical Examination by Certifying Surgeon	Result of Medical Examination	work, state Period of Suspension with Detailed Reasons	Certified fit to resume duty on with signature of certifying surgeon	unfitness or suspenstion issued to	Signature with Date of Certifying Surgeon
1	2	3	4	5	6	7	8	9	10	11	12	13	14	15	
28	11066	Raghavendra D. Shamannavar	Male	34	Engineering	NA	NA			13-01-24	FIT	NA	NA	NA	
29	11067	Arjun S. Pujari	Male	27	Co-Generation	NA	NA			13-01-24	FIT	NA	NA	NA	
30	11068	Kiran S. Mandeshi	Male	34	WTP	NA	NA			13-01-24	FIT	NA	NA	NA	
31	11069	Pravin R. Jadhav	Male	32	Engineering	NA	NA			13-01-24	FIT	NA	NA	NA	
32	11070	Ananda B. Unhale	Male	32	WTP	NA	NA			13-01-24	FIT	NA	NA	NA	
33	11073	Pravin S. Thakur	Male	38	WTP	NA	NA			13-01-24	FIT	NA	NA	NA	
34	11074	Dhareppa G. Mane	Male	25	Engineering	NA	NA			13-01-24	FIT	NA	NA	NA	
35	11075	Pradeep G. Mali	Male	37	Distillery	NA	NA			13-01-24	FIT	NA	NA	NA	
36	11078	Vijay Raj A. Dudhale	Male	28	Distillery	NA	NA			13-01-24	FIT	NA	NA	NA	
37	11079	Sunil P. Mhajshale	Male	37	WTP	NA	NA			13-01-24	FIT	NA	NA	NA	
38	11081	Sourabh R. Nandane	Male	24	Distillery	NA	NA			13-01-24	FIT	NA	NA	NA	
39	11084	Appanagouda B. Patil	Male	26	Distillery	NA	NA			13-01-24	FIT	NA	NA	NA	
40	11084	Jagannath D. Chavan	Male	30	Distillery	NA	NA			13-01-24	FIT	NA	NA	NA	
41	11088	Kiran R. Latte	Male	24	Distillery	NA	NA			13-01-24	FIT	NA	NA	NA	
42	11090	Sourabh S. Mane	Male	24	Distillery	NA	NA			13-01-24	FIT	NA	NA	NA	
43	11091	Akshay Kumar S. Gaikwad	Male	28	Engineering	NA	NA			13-01-24	FIT	NA	NA	NA	
44	11092	Sagar S. Zanje	Male	27	Distillery	NA	NA			13-01-24	FIT	NA	NA	NA	
45	11093	Suraj S. Patil	Male	25	Distillery	NA	NA			13-01-24	FIT	NA	NA	NA	
46	11094	Akash A. Powar	Male	24	Distillery	NA	NA			13-01-24	FIT	NA	NA	NA	
47	11095	Anand Shankar Naik	Male	31	Engineering	NA	NA			13-01-24	FIT	NA	NA	NA	
48	11097	Shivshant S. Waghmare	Male	28	Distillery	NA	NA			13-01-24	FIT	NA	NA	NA	
49	11100	Amol S. Kachare	Male	44	Engineering	NA	NA			13-01-24	FIT	NA	NA	NA	
50	11101	Ganesh S. Patil	Male	28	Distillery	NA	NA			13-01-24	FIT	NA	NA	NA	
51	11102	Mahesh B. Kattikar	Male	29	Distillery	NA	NA			13-01-24	FIT	NA	NA	NA	
52	11104	Ketan B. Patil	Male	28	Electrician	NA	NA			13-01-24	FIT	NA	NA	NA	
53	11107	Shreyansh B. Girmal	Male	24	Distillery	NA	NA			13-01-24	FIT	NA	NA	NA	
54	11108	Ramazan D. Keruri	Male	40	Engineering	NA	NA			13-01-24	FIT	NA	NA	NA	

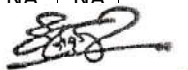
  
 कारखाने अधिनियम १९४८ च्या कलम १०(२) प्रमाणे  
 कोल्हापूर जिल्हाकरिता  
 प्राधिकृत प्रमाणकशाल्यधिकारिता  
 क्र. ACS 15-AM/2016

FORM 7

( See Rule 18 (7) and schedules II,III,IV,VI,VIII,X,XI,XIII,XIV,XV,XVII,XVIII & XX to Rule 114 )  
**SHRI GURUDATT SUGARS LIMITED**  
 ( Health Register )

**CERTIFYING SURGEON**  
**DR. ARVIND MANE**  
 MBBS DPH AFIH.(MUMBAI)

( In respect of persons employed in occupations declared to be dangerous operations under sections 87 )

Pramutech Services Ltd.

From: { 12-01-24 To 11-01-25 }

Serial No.	Works No.	Name of Worker	Sex	Age (Last birth -day)	Dept. of employment of present work	Date of Leaving or Transfer to Other	Reason For Leaving Transfer of Discharge	Nature of Job or Occupation	Raw Material or by Product Handeled	Date of Medical Examination by Certifying Surgeon	Result of Medical Examination	work, state Period of Suspension with Detailed Reasons	Certified fit to resume duty on with signature of certifying surgeon	unfitness or suspection issued to	Signature with Date of Certifying Surgeon
1	2	3	4	5	6	7	8	9	10	11		12	13	14	15
55	11109	Gorakanath D. Mane	Male	49	Distillery	NA	NA			13-01-24	FIT	NA	NA	NA	
56	11111	Vikrant B. Kamble	Male	37	Boiler	NA	NA			13-01-24	FIT	NA	NA	NA	
57	11113	Sachin T. Jadhav	Male	26	WDT	NA	NA			13-01-24	FIT	NA	NA	NA	
58	11114	Adesh V. Gundkalle	Male	26	Distillery	NA	NA			13-01-24	FIT	NA	NA	NA	
59	11116	Suyash S. Ghatage	Male	22	Distillery	NA	NA			13-01-24	FIT	NA	NA	NA	
60	-	Yogesh V. Kumbhar	Male	28	Engineering	NA	NA			13-01-24	FIT	NA	NA	NA	

  
 कारखाने अधिनियम १९४८ च्या कलम १०(२) प्रमाणे  
 कोल्हापूर जिल्हाकरिता  
 प्राधिकृत प्रमाणकशल्यचिकित्सक  
 क्र. ACS 15-AM/2016

## FORM 7

( See Rule 18 (7) and schedules II,III,IV,VI,VIII,X,XI,XIII,XIV,XV,XVII,XVIII & XX to Rule 114 )  
**SHRI GURUDATT SUGARS LIMITED**  
 ( Health Register )

( In respect of persons employed in occupations declared to be dangerous operations under sections 87 )

Raju Tambekar

From: { 12-01-24 To 11-01-25 }

**CERTIFYING SURGEON**  
**DR. ARVIND MANE**  
 MBBS DPH AFIH.(MUMBAI)

Serial No.	Works No.	Name of Worker	Sex	Age (Last birth -day)	Dept. of employment of present work	Date of Leaving or Transfer to Other	Reason For Leaving Transfer of Discharge	Nature of Job or Occupation	Raw Material or by Product Handeled	Date of Medical Examination by Certifying Surgeon	Result of Medical Examination	work, state Period of Suspension with Detailed Reasons	Certified fit to resume duty on with signature of certifying surgeon	unfitness or suspection issued to	Signature with Date of Certifying Surgeon
1	2	3	4	5	6	7	8	9	10	11		12	13	14	15
1 -		Appaso L. Latte	Male	50	Packing	NA	NA			13-01-24	FIT	NA	NA	NA	
2 -		Imran S. Kunundwade	Male	35	Sugar Godwan	NA	NA			13-01-24	FIT	NA	NA	NA	
3 -		Kedar K. Nirmale	Male	26	Sugar Godwan	NA	NA			13-01-24	FIT	NA	NA	NA	
4 -		Nagesh D. Gaste	Male	28	Sugar Godwan	NA	NA			13-01-24	FIT	NA	NA	NA	



कारखाने अधिनियम १९४८ च्या कलम १०(२) प्रमाणे  
 कोल्हापूर जिल्हाकरिता  
 प्राधिकृत प्रमाणकशल्यचिकित्सक  
 क्र. ACS 15-AM/2016

**FORM 7**

( See Rule 18 (7) and schedules II,III,IV,VI,VIII,X,XI,XIII,XIV,XV,XVII,XVIII & XX to Rule 114 )  
**SHRI GURUDATT SUGARS LIMITED**  
 ( Health Register )  
 ( In respect of persons employed in occupations declared to be dangerous operations under sections 87 )

**CERTIFYING SURGEON**  
**DR. ARVIND MANE**  
 MBBS DPH AFIH.(MUMBAI)

V.D.P.

From: { 12-01-24 To 11-01-25 }

Serial No.	Works No.	Name of Worker	Sex	Age (Last birth -day)	Dept. of employment of present work	Date of Leaving or Transfer to Other	Reason For Leaving Transfer of Discharge	Nature of Job or Occupation	Raw Material or by Product Handeled	Date of Medical Examination by Certifying Surgeon	Result of Medical Examination	work, state Period of Suspension with Detailed Reasons	Certified fit to resume duty on with signature of certifying surgeon	unfitness or suspenstion issued to	Signature with Date of Certifying Surgeon
1	2	3	4	5	6	7	8	9	10	11	12	13	14	15	
1	1505	Vidyasagar B. Chavan	Male	28	Engineering	NA	NA			13-01-24	FIT	NA	NA	NA	
2	15034	Krishnat A. Shinde	Male	30	WTP	NA	NA			13-01-24	FIT	NA	NA	NA	
3	15035	Sagar S. Patil	Male	27	Distillery	NA	NA			13-01-24	FIT	NA	NA	NA	
4	15038	Mahesh B. Badame	Male	32	Distillery	NA	NA			13-01-24	FIT	NA	NA	NA	
5	15039	Vinayak Rajaram Prathnahalli	Male	25	Distillery	NA	NA			13-01-24	FIT	NA	NA	NA	
6	15041	Nikhil N. Patil	Male	21	Sanitation	NA	NA			13-01-24	FIT	NA	NA	NA	
7	15042	Ramchandra A. Vankore	Male	32	Sanitation	NA	NA			13-01-24	FIT	NA	NA	NA	
8	15043	Prakash S. Uadar	Male	39	ETP	NA	NA			13-01-24	FIT	NA	NA	NA	
9	15044	Ashitosh S. Pawar	Male	24	WTP	NA	NA			13-01-24	FIT	NA	NA	NA	
10	15045	Basagonda C. Patil	Male	27	WTP	NA	NA			13-01-24	FIT	NA	NA	NA	
11	15051	Sourabh S. Koli	Male	25	Sanitation	NA	NA			13-01-24	FIT	NA	NA	NA	
12	15052	Rakesh Tatoba Gawade	Male	24	Biofertilizer	NA	NA			13-01-24	FIT	NA	NA	NA	
13	15054	Omkar Gajanan Bore	Male	26	Distillery	NA	NA			13-01-24	FIT	NA	NA	NA	
14	15055	Altaf M. Tashildar	Male	24	WTP	NA	NA			13-01-24	FIT	NA	NA	NA	
15	15057	Aaditya Sunil More	Male	24	WTP	NA	NA			13-01-24	FIT	NA	NA	NA	
16	15058	Shoukat I. Naikwade	Male	49	Sanitation	NA	NA			13-01-24	FIT	NA	NA	NA	
17	15061	Sachin S. Pakhare	Male	38	Sanitation	NA	NA			13-01-24	FIT	NA	NA	NA	
18	15062	Vinayak K. Vasawade	Male	28	Caneyard	NA	NA			13-01-24	FIT	NA	NA	NA	
19	15064	Prakul P. Walake	Male	31	Agriculture	NA	NA			13-01-24	FIT	NA	NA	NA	
20	15071	Abhishek V. Badame	Male	25	Default	NA	NA			13-01-24	FIT	NA	NA	NA	
21	15073	Pandurang B. Sutar	Male	28	Caneyard	NA	NA			13-01-24	FIT	NA	NA	NA	
22	15077	Sandip R. Koli	Male	24	Electrician	NA	NA			13-01-24	FIT	NA	NA	NA	
23	15079	Atul Shankar Bele	Male	23	Engineering	NA	NA			13-01-24	FIT	NA	NA	NA	
24	15082	Shiddheshwar R. Gote	Male	41	Manufacturing	NA	NA			13-01-24	FIT	NA	NA	NA	
25	15085	Sachin M. Chavan	Male	25	Manufacturing	NA	NA			13-01-24	FIT	NA	NA	NA	
26	15087	Yugandhar Y. Shinde	Male	27	WTP	NA	NA			13-01-24	FIT	NA	NA	NA	
27	15088	Shivraj R. Koli	Male	25	Engineering	NA	NA			13-01-24	FIT	NA	NA	NA	

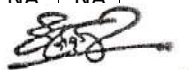
  
 कारखाने अधिनियम १९४८ च्या कलम १०(२) प्रमाणे  
 कोल्हापूर जिल्हाकरिता  
 प्राधिकृत प्रमाणकशाल्यधिकारिता  
 क्र. ACS 15-AM/2016

**FORM 7**

( See Rule 18 (7) and schedules II,III,IV,VI,VIII,X,XI,XIII,XIV,XV,XVII,XVIII & XX to Rule 114)

**SHRI GURUDATT SUGARS LIMITED**

**( Health Register )**

**( In respect of persons employed in occupations declared to be dangerous operations under sections 87 )**

**CERTIFYING SURGEON**

**DR. ARVIND MANE**

**MBBS DPH AFIH.(MUMBAI)**

V.D.P.

From: { 12-01-24 To 11-01-25 }

Serial No.	Works No.	Name of Worker	Sex	Age (Last birth -day)	Dept. of employment of present work	Date of Leaving or Transfer to Other	Reason For Leaving Transfer of Discharge	Nature of Job or Occupation	Raw Material or by Product Handeled	Date of Medical Examination by Certifying Surgeon	Result of Medical Examination	work, state Period of Suspension with Detailed Reasons	Certified fit to resume duty on with signature of certifying surgeon	unfitness or suspenstion issued to	Signature with Date of Certifying Surgeon
1	2	3	4	5	6	7	8	9	10	11	12	13	14	15	
28	15090	Pradip A. Naik	Male	26	Manufacturing	NA	NA			13-01-24	FIT	NA	NA	NA	
29	15091	Mahesh S. Mali	Male	38	Engineering	NA	NA			13-01-24	FIT	NA	NA	NA	
30	15093	Chidanand A. Karadage	Male	36	Manufacturing	NA	NA			13-01-24	FIT	NA	NA	NA	
31	15094	Rohan S. Patil	Male	27	Caneyard	NA	NA			13-01-24	FIT	NA	NA	NA	
32	15096	Vithal R. Gavade	Male	27	Default	NA	NA			13-01-24	FIT	NA	NA	NA	
33	15097	Mahesh S. Vankundre	Male	32	WTP	NA	NA			13-01-24	FIT	NA	NA	NA	
34	15098	Abhishek S. Mang	Male	25	Manufacturing	NA	NA			13-01-24	FIT	NA	NA	NA	
35	15099	Rakesh D. Koli	Male	30	Engineering	NA	NA			13-01-24	FIT	NA	NA	NA	
36	15102	Rahul R. Sunger	Male	28	Engineering	NA	NA			13-01-24	FIT	NA	NA	NA	
37	15108	Prathamesh V. Katarak	Male	27	WTP	NA	NA			13-01-24	FIT	NA	NA	NA	
38	15110	Suraj S. Badame	Male	26	Manufacturing	NA	NA			13-01-24	FIT	NA	NA	NA	
39	15114	Akshay D. Magdum	Male	25	WTP	NA	NA			13-01-24	FIT	NA	NA	NA	
40	15116	Ramdas A. Vasankar	Male	22	Engineering	NA	NA			13-01-24	FIT	NA	NA	NA	
41	15121	Subham S. Patil	Male	25	Engineering	NA	NA			13-01-24	FIT	NA	NA	NA	
42	15131	Dhiraj U. Tavdare	Male	22	Engineering	NA	NA			13-01-24	FIT	NA	NA	NA	
43	15132	Babu A. Koravi	Male	20	Manufacturing	NA	NA			13-01-24	FIT	NA	NA	NA	
44	15135	Harshad V. Ugare	Male	23	Production	NA	NA			13-01-24	FIT	NA	NA	NA	
45	15138	Shubham B. Bhatale	Male	27	Distillery	NA	NA			13-01-24	FIT	NA	NA	NA	
46	15139	Sumit P. Jadhav Koravi	Male	23	Engineering	NA	NA			13-01-24	FIT	NA	NA	NA	
47	15145	Vahid Babar Kurade	Male	20	Boiler	NA	NA			13-01-24	FIT	NA	NA	NA	
48	15146	Vishal Sanjay Phandare	Male	21	Engineering	NA	NA			13-01-24	FIT	NA	NA	NA	
49	15148	Vishal Suresh Khot	Male	25	Distillery	NA	NA			13-01-24	FIT	NA	NA	NA	
50	15150	Anil R. Patil	Male	47	Electrician	NA	NA			13-01-24	FIT	NA	NA	NA	
51	15161	Santosh K. Dhavale	Male	24	WTP	NA	NA			13-01-24	FIT	NA	NA	NA	
52	15164	Shankar D. Killedar	Male	25	Sanitation	NA	NA			13-01-24	FIT	NA	NA	NA	
53	15166	Aakash Sanjay Vadar	Male	22	Distillery	NA	NA			13-01-24	FIT	NA	NA	NA	
54	15170	Ramchandra B. Nandikuale	Male	41	Time Office	NA	NA			13-01-24	FIT	NA	NA	NA	

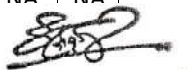
  
 कारखाने अधिनियम १९४८ च्या कलम १०(२) प्रमाणे  
 कोल्हापूर जिल्हाकरिता  
 प्राधिकृत प्रमाणकशाल्यधिकारिता  
 क्र. ACS 15-AM/2016

**FORM 7**

**( See Rule 18 (7) and schedules II,III,IV,VI,VIII,X,XI,XIII,XIV,XV,XVII,XVIII & XX to Rule 114 )**  
**SHRI GURUDATT SUGARS LIMITED**  
**( Health Register )**  
**( In respect of persons employed in occupations declared to be dangerous operations under sections 87 )**

**CERTIFYING SURGEON**  
**DR. ARVIND MANE**  
**MBBS DPH AFIH.(MUMBAI)**

V.D.P.

From: { 12-01-24 To 11-01-25 }

Serial No.	Works No.	Name of Worker	Sex	Age (Last birth -day)	Dept. of employment of present work	Date of Leaving or Transfer to Other	Reason For Leaving Transfer of Discharge	Nature of Job or Occupation	Raw Material or by Product Handeled	Date of Medical Examination by Certifying Surgeon	Result of Medical Examination	work, state Period of Suspension with Detailed Reasons	Certified fit to resume duty on with signature of certifying surgeon	unfitness or suspenstion issued to	Signature with Date of Certifying Surgeon
1	2	3	4	5	6	7	8	9	10	11	12	13	14	15	
55	15175	Moshin A. Jamadar	Male	24	Manufacturing	NA	NA			13-01-24	FIT	NA	NA	NA	
56	15177	Sushant S. Desai	Male	24	WTP	NA	NA			13-01-24	FIT	NA	NA	NA	
57	15180	Rahul M. Pakhare	Male	23	Engineering	NA	NA			13-01-24	FIT	NA	NA	NA	
58	15187	Gurudatt S. Koli	Male	23	Engineering	NA	NA			13-01-24	FIT	NA	NA	NA	
59	15188	Sourabh S. Solase	Male	24	Distillery	NA	NA			13-01-24	FIT	NA	NA	NA	
60	15189	Akshay V. Patil	Male	26	Manufacturing	NA	NA			13-01-24	FIT	NA	NA	NA	
61	15191	Dhananjay A. Nasalapure	Male	29	Distillery	NA	NA			13-01-24	FIT	NA	NA	NA	
62	15192	Amol P. Birange	Male	23	Distillery	NA	NA			13-01-24	FIT	NA	NA	NA	
63	15194	Sanket R. Dangre	Male	22	WTP	NA	NA			13-01-24	FIT	NA	NA	NA	
64	15196	Adarsh Y. Patil	Male	24	Manufacturing	NA	NA			13-01-24	FIT	NA	NA	NA	
65	15201	Shubham S. Koli	Male	24	Electrician	NA	NA			13-01-24	FIT	NA	NA	NA	
66	15202	Umesh B. Bawadekar	Male	29	ETP	NA	NA			13-01-24	FIT	NA	NA	NA	
67	15204	Raj A. Patil	Male	30	Engineering	NA	NA			13-01-24	FIT	NA	NA	NA	
68	15205	Ashok A. Koli	Male	28	Electrician	NA	NA			13-01-24	FIT	NA	NA	NA	
69	15206	Omkar V. Patil	Male	23	WTP	NA	NA			13-01-24	FIT	NA	NA	NA	
70	15207	Chandan N. Sahani	Male	30	Engineering	NA	NA			13-01-24	FIT	NA	NA	NA	
71	15208	Shambhu S. Sing	Male	36	Default	NA	NA			13-01-24	FIT	NA	NA	NA	
72	15209	Satyanand V. Gupta	Male	21	Default	NA	NA			13-01-24	FIT	NA	NA	NA	
73	-	Abhishek Sanjay Phalle	Male	23	-	NA	NA			13-01-24	FIT	NA	NA	NA	
74	-	Anil S. Koli	Male	48	-	NA	NA			13-01-24	FIT	NA	NA	NA	
75	-	Pandurang A. Susavare	Male	38	-	NA	NA			13-01-24	FIT	NA	NA	NA	
76	-	Uday S. Patil	Male	40	Boiler	NA	NA			13-01-24	FIT	NA	NA	NA	
77	-	Prathmesh S. Chavan	Male	23	Co-Generation	NA	NA			13-01-24	FIT	NA	NA	NA	
78	-	Kumar S. Birandage	Male	21	Distillery	NA	NA			13-01-24	FIT	NA	NA	NA	
79	-	Sammed R. Vathare	Male	22	Electrician	NA	NA			13-01-24	FIT	NA	NA	NA	
80	-	Sourabh S. Ugare	Male	21	Electrician	NA	NA			13-01-24	FIT	NA	NA	NA	
81	-	Abhishek A. Ambupe	Male	21	Electrician	NA	NA			13-01-24	FIT	NA	NA	NA	

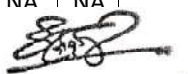
  
 कारखाने अधिनियम १९४८ च्या कलम १०(२) प्रमाणे  
 कोल्हापूर जिल्हाकरिता  
 प्राधिकृत प्रमाणकशल्यचिकित्सक  
 क्र. ACS 15-AM/2016

## FORM 7

( See Rule 18 (7) and schedules II,III,IV,VI,VIII,X,XI,XIII,XIV,XV,XVII,XVIII & XX to Rule 114 )  
**SHRI GURUDATT SUGARS LIMITED**  
 ( Health Register )  
 ( In respect of persons employed in occupations declared to be dangerous operations under sections 87 )

**CERTIFYING SURGEON**  
**DR. ARVIND MANE**  
 MBBS DPH AFIH.(MUMBAI)

V.D.P.

From: { 12-01-24 To 11-01-25 }

Serial No.	Works No.	Name of Worker	Sex	Age (Last birth -day)	Dept. of employment of present work	Date of Leaving or Transfer to Other	Reason For Leaving Transfer of Discharge	Nature of Job or Occupation	Raw Material or by Product Handeled	Date of Medical Examination by Certifying Surgeon	Result of Medical Examination	work, state Period of Suspension with Detailed Reasons	Certified fit to resume duty on with signature of certifying surgeon	unfitness or suspection issued to	Signature with Date of Certifying Surgeon
1	2	3	4	5	6	7	8	9	10	11		12	13	14	15
82	-	Shubham R. Manjare	Male	21	Engineering	NA	NA			13-01-24	FIT	NA	NA	NA	
83	-	Vijay D. Patil	Male	33	Sugar Godwan	NA	NA			13-01-24	FIT	NA	NA	NA	
84	-	Vishvajit R. Shivpure	Male	20	WTP	NA	NA			13-01-24	FIT	NA	NA	NA	
85	-	Shital S. Patil	Male	39	WTP	NA	NA			13-01-24	FIT	NA	NA	NA	
86	-	Aadarsh K. Sutar	Male	19	WTP	NA	NA			13-01-24	FIT	NA	NA	NA	
87	-	Unishabh V. Magdum	Male	24	WTP	NA	NA			13-01-24	FIT	NA	NA	NA	

  
 कारखाने अधिनियम १९४८ च्या कलम १०(२) प्रमाणे  
 कोल्हापूर जिल्हाकरिता  
 प्राधिकृत प्रमाणकशल्यचिकित्सक  
 क्र. ACS 15-AM/2016



F. No. J-11011/41/2015-IA-II (I)  
Government of India  
Ministry of Environment, Forest and Climate Change  
(Impact Assessment Division)

Indira Paryavaran Bhawan  
Aliganj, Jor Bagh Road,  
New Delhi -110 003

Telefax: 011-24695365  
E-mail: [yogendra78@nic.in](mailto:yogendra78@nic.in)

Dated: 20<sup>th</sup> March, 2017

To,

The Chief Executive Officer  
M/s Shri Gurudatt Sugars Limited  
Gat No.61/A, Akiwat - Takaliwadi Road  
Takaliwadi, Taluka Shirol  
District - Kolhapur - 416 108  
Maharashtra

**Sub: Expansion of Sugar Plant (4900 TCD to 6000 TCD) and Co-generation Power Plant (15 MW to 21 MW) by M/s Shri Gurudatt Sugars Limited at Gat No.61/A, Akiwat-Takaliwadi Road, Takaliwadi, Taluka Shirol, District - Kolhapur, Maharashtra - Environmental Clearance - reg.**

**Ref: Online Proposal No. IA/MH/IND2/59911/2014 dated 22<sup>nd</sup> October, 2016.**

Sir,

This has reference to your online proposal no. IA/MH/IND2/59911/2014 dated 22<sup>nd</sup> October, 2016, along with project documents including Form I, Terms of References, Pre-feasibility Report and EIA/EMP Report with public hearing report regarding the above mentioned project.

2. The Ministry of Environment, Forest and Climate Change has examined the application. It is noted that the proposal is Expansion of Sugar Plant (4900 TCD to 6000 TCD) and Co-generation Power Plant (15 MW to 21 MW) by M/s Shri Gurudatt Sugars Limited at Gat No.61/A, Akiwat-Takaliwadi Road, Takaliwadi, Taluka Shirol, District-Kolhapur, Maharashtra. As informed and as per the documents submitted by the Project Proponent (PP), no additional land is required as the project is proposed in the premises of sugar plant. The land area is 55 Acres. Area for green belt is 15 Acres. The total cost of the project is Rs. 86.34 crores. Raw Material is Sugarcane and Bagasse. No Protected area/Eco-sensitive area/Reserve forests are reported to be located within 10 km area of the project site. Krishna River (3 km), Panchganga River (5 km), and Dudhganga River (7 Km) are located within 10 km radius of the project site. Karnataka State is located within 4 km from the project site. The project thus falls in the interstate boundary region of Karnataka and Maharashtra. The plant will have the following configuration and production capacity:



Units	Existing Capacity	Proposed Capacity	Total Capacity after expansion	Working days
Sugar Plant	4900 TCD	1100 TCD	6000 TCD	160
Cogeneration Plant	15 MW	6 MW	21 MW	160+124

3. All Sugar Industry ( $\geq 5000$  TCD cane crushing capacity) are listed at Sl. No. 5(j) of Schedule of EIA Notification under Category 'B'. However, considering the general condition that the project is located at distance of 4 km from the interstate boundary of Karnataka State, the project is considered under Category 'A' and are appraised at Central Level by Expert Appraisal Committee (EAC).

4. The project proposal was considered by the Expert Appraisal Committee (Industry-2) in its 36<sup>th</sup> meeting held during 16<sup>th</sup>- 17<sup>th</sup> March, 2015 and recommended Terms of References (TORs) for the Project. The TOR has been issued by Ministry vide letter dated 18<sup>th</sup> May, 2015.

5. The project proposal was considered by the Expert Appraisal Committee (Industry -2) in its 17<sup>th</sup> meeting held during 26<sup>th</sup> - 29<sup>th</sup> December, 2016. The Project Proponent and the accredited consultant M/s SD Engineering Services Pvt. Ltd, Aurangabad, gave a detailed presentation on the salient features of the project and proposed environmental protection measures to be undertaken, as per Terms of References (TORs) awarded in the 36<sup>th</sup> meeting of the EAC held during 16<sup>th</sup> - 17<sup>th</sup> March, 2015.

6. The State Pollution Control Board, Maharashtra has issued CTE vide letter no. 1.0/BO/CAC-CELL/EIC No. KP-15740-14/EIC. 4729 dated 27/04/2015 and CTO vide letter no. 1.0/BO/CAC CELL/EIC-KP-17292-15/ O&R/CAC-418 dated 8/10/2016. The existing unit has been operating with Consent to Operate from the State Pollution Control Board. Consent of Industry was valid up to 31.07.2016. The PP has informed the EAC that the application for renewal is submitted and same is under consideration of the SPCB which will be issued under auto-renewal policy of State Government.

7. Public Hearing for the proposed project has been conducted by the Maharashtra State Pollution Control Board 24.08.2016. The EAC has deliberated upon the issues raised during the public hearing. The concerns were raised regarding employment opportunities, pollution due to waste water discharge from plant, etc. The EAC noted that the issues have satisfactorily been responded by the project proponent and incorporated in the final EIA-EMP report.

8. The Project Proponent has informed the EAC that the ambient air quality monitoring was carried out at 9 locations during October, 2015- December, 2015 and submitted baseline data indicates that ranges of concentrations of PM<sub>10</sub> (25  $\mu\text{g}/\text{m}^3$  to 47.8  $\mu\text{g}/\text{m}^3$ ), PM<sub>2.5</sub> (7.5  $\mu\text{g}/\text{m}^3$  to 18.5  $\mu\text{g}/\text{m}^3$ ), SO<sub>2</sub> (7.1  $\mu\text{g}/\text{m}^3$  to 9.2  $\mu\text{g}/\text{m}^3$ ), CO (0.09  $\mu\text{g}/\text{m}^3$  -0.16 $\mu\text{g}/\text{m}^3$ ) and NO<sub>x</sub> (8.6  $\mu\text{g}/\text{m}^3$  to 11.1 $\mu\text{g}/\text{m}^3$ ) respectively.

9. The total requirement of water for sugar and cogeneration is 1405.25 m<sup>3</sup>/day for process, cooling, boiler and domestic purpose. Fresh water

Permission has been obtained from the concerned authority. Balance water shall be met through recycling of condensate water. Under no circumstances ground water shall be used in the factory.

10. Power requirement is 6 MW/day for sugar and co-gen unit, the same is met through own generation. The steam generating system for the proposed Cogeneration Project comprises of two multi-fuel fired boiler with a Maximum Continuous Rating (MCR) of 70 TPH and 40 TPH (total capacity 110 TPH), with the outlet steam parameters at 45 kg/cm<sup>2</sup> and 5000 C. Fuel for Boiler is Bagasse. The bagasse requirement is 182054 MT/year.

11. The PP has submitted a letter no. MPCB/RO/KOP- 2878/2016 dated 28/07/2016 issued by the Regional Officer, Kolhapur, Maharashtra Pollution Control Board mentioning that the effluent/wastewater generated by the existing plant is well within the prescribed limit, based on the direction of the EAC.

12. The EAC, in its 17<sup>th</sup> meeting held on 26<sup>th</sup>- 29<sup>th</sup> December, 2016 has found that the final EIA/EMP report submitted by the PP is adequate. The EAC after detailed deliberations, on the basis of the information and presentation made by the PP, has recommended the project for environmental clearance with certain conditions.

13. Based on the proposal and information submitted by the Project Proponent, and considering the recommendation of the Expert Appraisal Committee (Industry-2), the Ministry of Environment, Forest and Climate Change hereby accords Environmental Clearance to the above project under the provisions of EIA Notification dated 14<sup>th</sup> September 2006, subject to the compliance of the following Specific and General Conditions:

**A. Specific Conditions:**

- i. Zero liquid Discharge System shall be ensured.
- ii. Water requirement to be reduced at extent possible by using latest process methodology being used worldwide.
- iii. Fly Ash be generated shall be sent to nearby cement industry.
- iv. Green belt (10 m wide) of perennial plant species like Neem, Sesam, Teak etc., to be developed around the plant periphery ensuring the 33% area of the plant as green area. The Forest department may be consulted in this regard.
- v. Air emissions from all point source to be controlled by latest technology instruments. The emissions shall conform to the limits imposed by Maharashtra Pollution Control Board (MPCB).
- vi. Periodic soil and water sampling in nearby villages and water bodies to be done by the Project Authorities through 3<sup>rd</sup> part expert and report shall be submitted to the concerned regional office of the Ministry.
- vii. RO plant of sufficient capacity to be installed in the nearby villages to ensure safe drinking water supply. Maintenance of the RO plant will be owned by the Project Authorities.
- viii. Health check-up camps to be organized periodically in nearby villages.

- ix. A regular environmental manager having PG qualification in environmental sciences/environmental engineering to be appointed for looking after the environmental management practices in the plant.
- x. Automatic/online monitoring system (24 x 7 monitoring devices) for flow measurement and relevant pollutants in the treatment system to be installed. The data to be made available to the respective SPCB and in the Company's website.

**B. General Conditions:**

- i. The project authorities must strictly adhere to the stipulations made by the Maharashtra Pollution Control Board, State Government and any other statutory authority.
- ii. No further expansion or modifications in the plant shall be carried out without prior approval of the Ministry of Environment, Forest and Climate Change. In case of deviations or alterations in the project proposal from those submitted to this Ministry for clearance, a fresh reference shall be made to the Ministry to assess the adequacy of conditions imposed and to add additional environmental protection measures required, if any.
- iii. The locations of ambient air quality monitoring stations shall be decided in consultation with the State Pollution Control Board (SPCB) and it shall be ensured that at least one station is installed in the upwind and downwind direction as well as where maximum ground level concentrations are anticipated.
- iv. The National Ambient Air Quality Emission Standards issued by the Ministry vide G.S.R. No. 826(E) dated 16<sup>th</sup> November, 2009 shall be followed.
- v. The overall noise levels in and around the plant area shall be kept well within the standards by providing noise control measures including acoustic hoods, silencers, enclosures etc. on all sources of noise generation. The ambient noise levels shall conform to the standards prescribed under Environment (Protection) Act, 1986 Rules, 1989 viz. 75 dBA (day time) and 70 dBA (night time).
- vi. The Company shall harvest rainwater from the roof tops of the buildings and storm water drains to recharge the ground water and use the same water for the process activities of the project to conserve fresh water.
- vii. Training shall be imparted to all employees on safety and health aspects of chemicals handling. Pre-employment and routine periodical medical examinations for all employees shall be undertaken on regular basis. Training to all employees on handling of chemicals shall be imparted.
- viii. The company shall also comply with all the environmental protection measures and safeguards proposed in the documents submitted to the Ministry. All the recommendations made in the EIA/EMP in respect of environmental management and risk mitigation measures relating to the project shall be implemented.



- ix. The company shall undertake all relevant measures for improving the socioeconomic conditions of the surrounding area. CSR activities shall be undertaken by involving local villages and administration.
- x. The company shall undertake eco-developmental measures including community welfare measures in the project area for the overall improvement of the environment.
- xi. A separate Environmental Management Cell equipped with full fledged laboratory facilities shall be set up to carry out the Environmental Management and Monitoring functions.
- xii. The company shall earmark sufficient funds towards capital cost and recurring cost per annum to implement the conditions stipulated by the Ministry of Environment, Forest and Climate Change as well as the State Government along with the implementation schedule for all the conditions stipulated herein. The funds so earmarked for environment management/pollution control measures shall not be diverted for any other purpose.
- xiii. A copy of the clearance letter shall be sent by the project proponent to concerned Panchayat, Zilla Parishad/Municipal Corporation, Urban local Body and the local NGO, if any, from whom suggestions/representations, if any, were received while processing the proposal.
- xiv. The project proponent shall also submit six monthly reports on the status of compliance of the stipulated Environmental Clearance conditions including results of monitored data (both in hard copies as well as by e-mail) to the respective Regional Office of MoEF&CC, the respective Zonal Office of CPCB and SPCB. A copy of Environmental Clearance and six monthly compliance status report shall be posted on the website of the company.
- xv. The environmental statement for each financial year ending 31<sup>st</sup> March in Form-V as is mandated shall be submitted to the concerned State Pollution Control Board as prescribed under the Environment (Protection) Rules, 1986, as amended subsequently, shall also be put on the website of the company along with the status of compliance of environmental clearance conditions and shall also be sent to the respective Regional Offices of MoEF&CC by e-mail.
- xvi. The project proponent shall inform the public that the project has been accorded environmental clearance by the Ministry and copies of the clearance letter are available with the SPCB/Committee and may also be seen at Website of the Ministry at <http://moef.nic.in>. This shall be advertised within seven days from the date of issue of the clearance letter, at least in two local newspapers that are widely circulated in the region of which one shall be in the vernacular language of the locality concerned and a copy of the same shall be forwarded to the concerned Regional Office of the Ministry.
- xvii. The project authorities shall inform the Regional Office as well as the Ministry, the date of financial closure and final approval of the project by the concerned authorities and the date of start of the project.



14. The Ministry may revoke or suspend the clearance, if implementation of any of the above conditions is not satisfactory.

15. The Ministry reserves the right to stipulate additional conditions, if found necessary. The company in a time bound manner will implement these conditions.

16. The above conditions will be enforced, *inter alia* under the provisions of the Water (Prevention & Control of Pollution) Act, 1974, Air (Prevention & Control of Pollution) Act, 1981, the Environment (Protection) Act, 1986, Hazardous Waste (Management, Handling and Trans-boundary Movement) Rules, 2008 and the Public Liability Insurance Act, 1991 along with their amendments and rules.

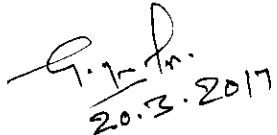
  
20.3.2017  
**(Yogendra Pal Singh)**  
**Scientist 'D'**

**Copy to:-**

1. The Secretary, Environment Department, Government of Maharashtra, 15<sup>th</sup> Floor, New Administrative Building, Mantralaya, Mumbai- 400 032.
2. The Additional Principal Chief Conservator of Forests (C), Ministry of Environment, Forest and Climate Change, Regional Office(WCZ), Ground Floor, East Wing, New Secretariat Building, Civil Line, Nagpur-440001.
3. The Chairman, Central Pollution Control Board, Parivesh Bhawan, CBD-cum-Office Complex East Arjun Nagar, Delhi - 110 032.
4. The Chairman, Maharashtra Pollution Control Board, Kalpataru Point, 3<sup>rd</sup> and 4<sup>th</sup> floor, Opp. Cine Planet, Sion Circle, Mumbai-400 022.
5. Monitoring Cell, Ministry of Environment, Forest and Climate Change, Indira Paryavaran Bhavan, Jor Bhag, New Delhi- 110 003.
6. Guard File/Monitoring File/Website/Record File.

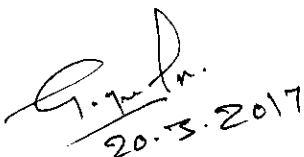
  
20.3.2017  
**(Yogendra Pal Singh)**  
**Scientist 'D'**